

LAND-MARK SURVEYING

Mark L. Miritz

Wisconsin Registered Land Surveyor S-2582

N9330 Knuteson Drive
Whitewater, WI 53190
Phone: (262) 495-3284
FAX: (262) 495-8421
LAND-MARKSURVEYING.COM

PLAT OF SURVEY

LOT 2 OF CERTIFIED SURVEY MAP NO. 3412 AS RECORDED IN
VOL. 19 OF CERTIFIED SURVEY MAPS ON PAGE 267, LOCATED
IN THE NORTHWEST 1/4 AND THE SOUTHWEST 1/4 OF THE
SOUTHEAST 1/4 OF SECTION 20, TOWN 3 NORTH, RANGE
16 EAST, WALWORTH COUNTY, WISCONSIN.

OWNERS: CHAD L. HUMMEL
JILL A HUMMEL
N6899 TOSEWOOD DR.
ELKHORN, WI. 53121

LOT 1

EXISTING
FOUNDATION
DETAIL

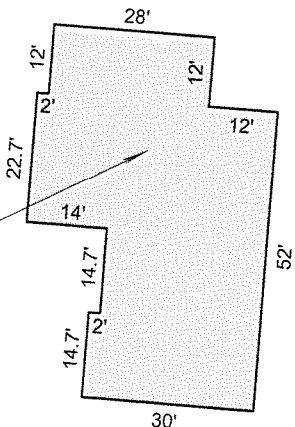

Ordered by: Schauder Building, Inc.
4115 North U.S. Highway 51
Janesville, WI. 53545-9674

GA341200002

LOT 2

(291,180 S.F.)

300' MIN BUILDING WIDTH

EXISTING
FOUNDATION
(SEE DETAIL)

JIM DRIVE

66' WIDE PRIVATE DRIVE EASEMENT

LOT 3

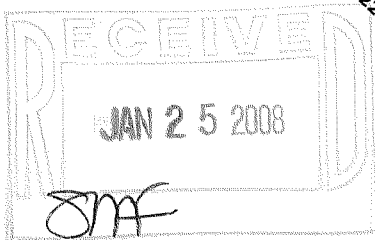

SOUTH 1/4 CORNER
SEC. 20-3-16

(S 88°26'57" W 660.99')
S 88°26'44" W 660.87'

FOUND IRON ROD IS
S 35°58' W 3.57'
FROM TRUE CORNER
SET 3/4" DIA.
ROD AT CORNER

C.T.H. "O"

W. LINE SE 1/4 SEC. 20-3-16
N 00°00'20" E 1807.42'

LEGEND

- FOUND IRON PIPE
- FOUND IRON ROD
- FOUND COUNTY MONUMENT
- SET IRON ROD, 24" LONG, WEIGHING
1.5 LBS./LINEAL FT., 3/4" DIA.
- (x x) RECORDED AS DIMENSION
- x — x — EXISTING FENCE



SCALE: 1" = 100 FEET

"I hereby certify that the above described property has
been surveyed by me or under my direction and that the
above map is a true representation thereof and shows the
size and location of the property, its exterior boundaries,
the location of all visible structures and dimensions of all
principal buildings thereon, boundary fences, apparent
easements, roadways and visible encroachments, if any."
"This survey is made for the use of the present owners of
the property, and also those who purchase, mortgage, or
guarantee the title thereto within one year from date
hereof."

MARK L. MIRITZ
WISCONSIN REGISTERED
LAND SURVEYOR S-2582

REVISED DEC. 9, 2007 TO SHOW FOUNDATION "AS BUILT" DATE: OCTOBER 1, 2007 JOB NO. 07.816

GA 3412-2

316-1956