

Plat of Survey

of

Lot 15 of Baywood Estates,

a subdivision located in the Northwest 1/4 of Section 1, Town 3 North,
Range 16 East, Town of Sugar Creek, Walworth County, Wisconsin.

As ammended by Affidavit recorded August 1, 1975
in Vol. 140 on Page 328 as Document No. 694567.

Surveyed for:

Baywood Property Owners Association

263 Westward Drive
Elkhorn, Wisconsin. 53121

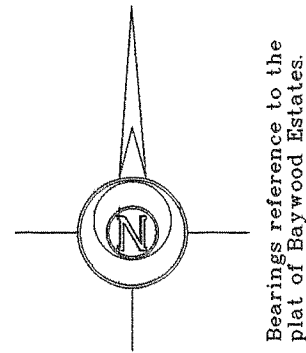

Lauderdale

Lake

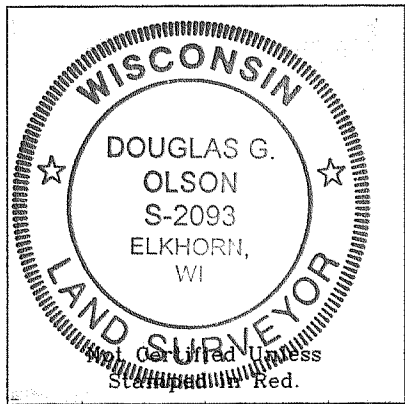

- Notes: 1) This survey plat is not certified unless signed and sealed in red ink.
2) This survey is subject to Wisconsin lien laws. This Plat of Survey is the notice of intent to file lien. Lien waiver required.

Copyright © 2007 by Jensen & Olson Land Surveying, LLC.

All rights reserved. No part of this survey plat may be reproduced or transmitted in any form by any means - graphic, electronic, or mechanical, including photocopying, tracing, or information storage and retrieval systems - without permission in writing from Douglas G. Olson, Jensen & Olson Land Surveying, LLC.

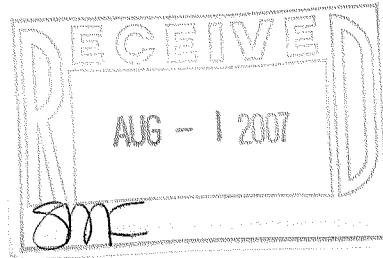

I, Douglas G. Olson, Wisconsin Registered Land Surveyor, do hereby certify that this survey was performed by me or under my direction in full compliance with the owner's/agent's instructions and Chapter 4-E 7 of the Wisconsin Administrative Code "Minimum Standards for Property Surveying" and that this map is an accurate representation thereof to the best of my knowledge and belief.

Douglas G. Olson
Wisconsin Registered Land Surveyor - 2093

Sheet 1 of 1 Sheets

Job Reference Number

2007.072

Legend

- Found Iron Pipe
- Found Iron Rod
- Recorded Information
- Utility Pole
- Utility Pedestal



Jensen & Olson Land Surveying, LLC

45 South Wisconsin Street P.O. Box 322
Elkhorn, Wisconsin. 53121
Telephone (262) 723-3434
Facsimile (262) 723-8044

Scale in Feet

1" = 30'

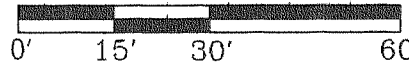

Survey Date: June 11, 2007.
Revisions: No. 1 - Boundary Survey

GBE - 15

316-1932