

Plat of Survey

of

Lots 9 through 12 of Block 3 of Lake Wandewega Highlands,

a subdivision located in the Northwest 1/4 of Section 12,
Town 3 North, Range 16 East, Town of Sugar Creek,
Walworth County, Wisconsin.

Surveyed for:

Coldwell Banker, Leith & Associates

102 North Wisconsin Street
Elkhorn, Wisconsin. 53121

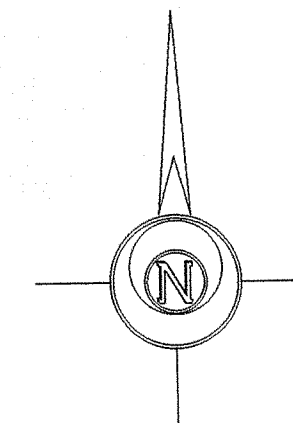

Bearings reference to Certified
Survey Map No. 204.

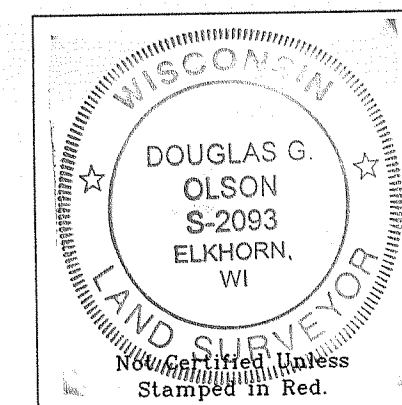
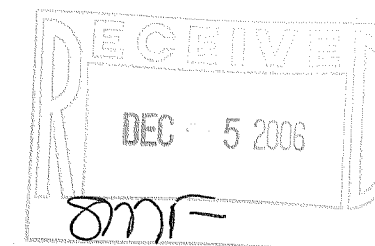

- Notes: 1) This survey plat is not certified unless signed and sealed in red ink.
- 2) This survey is subject to Wisconsin lien laws. This Plat of Survey is the notice of intent to file lien. Lien waiver required.

Copyright © 2006 by Jensen & Olson Land Surveying, LLC.

All rights reserved. No part of this survey plat may be reproduced or transmitted in any form by any means - graphic, electronic, or mechanical, including photocopying, tracing, or information storage and retrieval systems - without permission in writing from Douglas G. Olson, Jensen & Olson Land Surveying, LLC.

I hereby certify that I have surveyed the above described property and the map hereon is correct to the best of my professional knowledge and belief and shows the size and location of the property, its exterior boundaries, the location and dimensions of all visible structures thereon, boundary fences, apparent easements and roadways and visible encroachments, if any.

This survey is made for the exclusive use of the present owners of property, and also those who purchase, mortgage or guarantee title thereto, within one year from the date hereof.

Douglas G. Olson
Wisconsin Registered Land Surveyor - 2093

Survey Date: Sept. 7, 2006.

Revisions:

Scale in Feet
1" = 20'

40'
20'
10'
0'

Jensen & Olson Land Surveying, LLC

45 South Wisconsin Street P.O. Box 322

Elkhorn, Wisconsin, 53121

Telephone (262) 723-3434

Facsimile (262) 723-8044

Legend

- Found Iron Pipe in Concrete
- Found Iron Rod
- Found Iron Stake
- Found Pedestal
- Found Septic Vent
- Found Asphalt Surface
- Found Gravel
- Found Concrete Surface

Sheet 1 of 1 Sheets

Job Reference Number

2006.107

2006.107

316-1887

GWH-39