

# PERMIT PLAT

LOT 1 OF CERTIFIED SURVEY MAP NO. 2085

RECORDED IN VOL. 10 OF CERTIFIED SURVEY MAPS ON PAGE 61 AS DOC. NO. 222562  
LOCATED IN PART OF THE SOUTHWEST 1/4 OF THE NORTHEAST 1/4 OF SECTION 28,  
TOWN 3 NORTH, RANGE 16 EAST, TOWN OF SUGAR CREEK, WALWORTH COUNTY, WISCONSIN

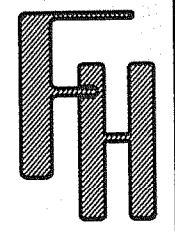

ASSIGNED N. LINE OF LOT 1 - C.S.M. 2085  
S 89°33'50" E

WORK ORDERED BY -  
JOHN PACZKOWSKI  
N5594 COBBLESTONE ROAD  
ELKHORN, WI 53121

FARRIS, HANSEN & ASSOCIATES, INC.  
ENGINEERING - ARCHITECTURE - SURVEYING  
7 RIDGWAY COURT P.O. BOX 437  
ELKHORN, WISCONSIN 53121  
OFFICE: (262) 723-2098 FAX: (262) 723-5886

## REVISIONS

PROJECT NO.  
7122  
DATE:  
08/10/06  
SHEET NO.  
1 OF 1

UNPLATTED LANDS

S 89°33'50" E 663.92'  
625.10'  
(625.22')

64.8'

246'

(S 00°00'30" W)  
S 00°00'22" E  
331.24'

UNPLATTED LANDS

LOT 1  
219,810 S.F.  
5.05 AC.

622.67'  
N 89°33'01" W 663.94'  
(N 89°32'10" W)

LOT 2 OF C.S.M. 2085

## LEGEND

○ = FOUND IRON PIPE STAKE  
(xxx) = RECORDED AS

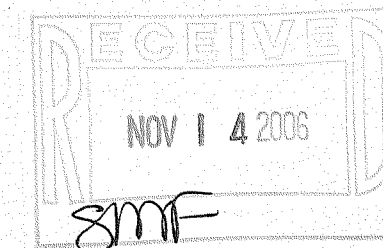

NOTE: COPIES OF THIS MAP TO WHICH THE FOLLOWING CERTIFICATE WILL APPLY SHOW SURVEYOR'S ORIGINAL SEAL AND SIGNATURE IN RED INK. COPIES BY ANY OTHER MEANS MAY HAVE ALTERATIONS WHICH DO NOT REPRESENT THE SURVEYOR'S WORK PRODUCT.

I HEREBY CERTIFY THAT THIS MAP IS A TRUE AND ACCURATE REPRESENTATION OF THE LOCATION OF THE BUILDINGS AND PROPOSED SHED IN RELATION TO THE BOUNDARY AS REPRESENTED BY MONUMENTS FOUND AND SHOWN REPRESENTING THE NORTHEAST, NORTHWEST, AND SOUTHWEST LOT CORNERS TO THE BEST OF MY PROFESSIONAL KNOWLEDGE AND BELIEF. NOTE THIS IS NOT A PLAT OF SURVEY AS DEFINED IN CHAPTER A-E 7 OF WISCONSIN ADMINISTRATIVE CODE

DATED: AUGUST 10, 2006

REVISED PRO. SHED LOCATION

PETER S. GORDON RLS 2101

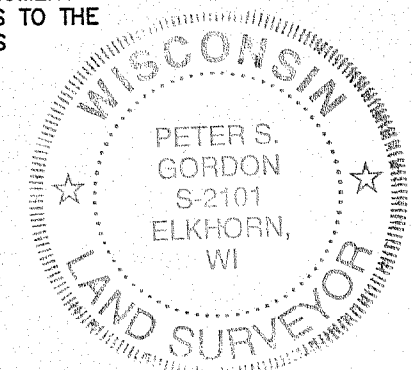

MAP SCALE IN FEET ORIGINAL 1" = 40'

316-1875