

Plat of Survey

of
Lots 1 through 18 of Block 4 and Lots 1 through 4 of Block 5 of North Lake Shore Woods,
a subdivision located in the Northeast 1/4 and the Southeast 1/4 of Section 5, Town 3 North, Range 16 East, Town of Sugar Creek, Walworth County, Wisconsin.

Surveyed for: **Tom McKee**
W6589 North Lake Shore Drive
Elkhorn, Wisconsin. 53121

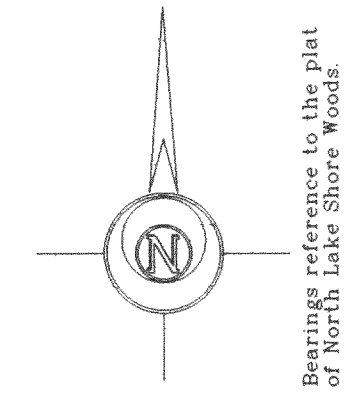

Copyright © 2005 by Jensen & Olson Land Surveying, LLC.
All rights reserved. No part of this survey plat may be reproduced or transmitted in any form by any means - graphic, electronic, or mechanical, including photocopying, tracing, or information storage and retrieval systems, without permission in writing from Douglas G. Olson, Jensen & Olson Land Surveying, LLC.
I hereby certify that I have surveyed the above described property and the map hereon is correct to the best of my professional knowledge and belief and shows the size and location of the property, its exterior boundaries, the location and dimensions of all visible structures thereon, boundary fences, apparent easements and roadways and visible encroachments, if any.
This survey is made for the exclusive use of the present owners of property, and also those who purchase, mortgage or guarantee title thereto, within one year from the date hereof.

Douglas G. Olson
Wisconsin Registered Land Surveyor - 2093

- Notes:
- 1) This survey plat is not certified unless signed and sealed in red ink.
 - 2) This survey is subject to Wisconsin lien laws. This Plat of Survey is the notice of intent to file lien. Lien waiver required.

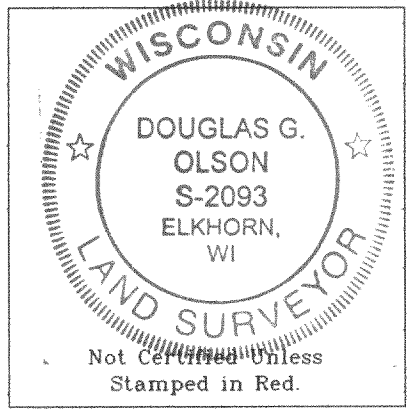

Survey Date: October 5, 2005.
Revisions:

Scale in Feet
1" = 30'
0 15 30 60

Jensen & Olson Land Surveying, LLC
45 South Wisconsin Street
Elkhorn, Wisconsin. 53121
Telephone (262) 723-3434
Facsimile (262) 723-8044

Legend
Found Iron Pipe
Found Iron Rod, 3/4" dia.
Set Iron Rod, 1-3/16" dia.
Set Cotton Spindle
Recorded Information 3/4" dia.
Utility Pole
Asphalt Surface
Concrete

Sheet 1 of 1 Sheets

Job Reference Number
2005.133

2005.133

GNLS-31 GNLS-31 316-1843