

PLAT OF SURVEY

J.K. SURVEYING INC.
 N3705 WILLOWBEND LANE
 LAKE GENEVA, WI, 53147
 262-248-3697

- OF -

UNIT 70 LAUDERDALE LAKES ESTATES, A CONDOMINIUM, ADDENDUM # 1
 LOCATED IN PART OF THE SOUTHEAST 1/4 AND SOUTHWEST 1/4 OF THE
 NORTHEAST 1/4 AND PART OF THE NORTHWEST 1/4 OF THE SOUTHEAST 1/4
 OF SECTION 1, TOWN 3 NORTH, RANGE 16 EAST, TOWN OF SUGER CREEK,
 WALWORTH COUNTY, WISCONSIN.

PREPARED FOR: SHOREWEST REALTORS
 C/O CATHY GRENNING
 830 E GENEVA ST.
 DELAVAN WI. 53115

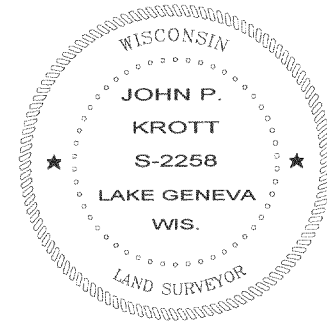

John P. Krott

JOHN KROTT S - 2258
 Wisconsin Registered Land Surveyor
 (original if signed in red)

DATED THIS THE 1st DAY OF JUNE 2005.

COMPARE LEGAL DESCRIPTION ABOVE AND DRAWING WITH DEED. FOR BUILDING RESTRICTIONS AND EASEMENTS NOT SHOWN, REFER TO DEED, ABSTRACT SOURCES AND LOCAL MUNICIPAL CODES. NOTIFY THE SURVEYOR IMMEDIATELY OF ANY DISCREPANCY.

"I hereby certify that I have surveyed the above described property and that the above map, to the best of my knowledge and belief, is a true representation thereof and shows the size and location of all visible structures, apparent easements and encroachments if any."
 This survey is made for the present owners of the property, and those who purchase, mortgage, or guarantee the title thereto, within one year from the date hereof.

C.L. S.T.H. "67" & U.S. "12"
 (93' WIDE ROAD)

N 00°35'02" W 538.81'
 (N 00°35'02" W 538.79')

60' WIDE LANDSCAPE EASEMENT

⊙ VENTS

C.L. LAKESHORE AVENUE
 (66' WIDE ROAD)

(S 24°49'54" E 395.39')
 (S 24°50'59" E 395.42')

⊕ CONCRETE LID
 ⊙ CLEANOUT

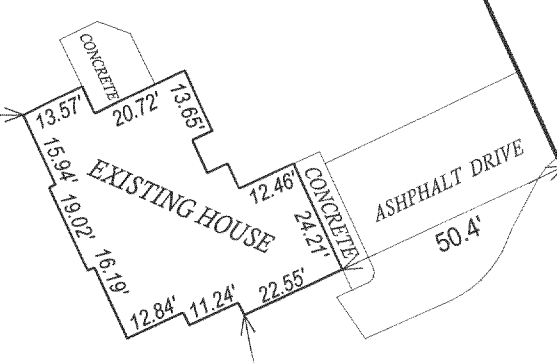

S 78°48'28" W 225.69'
 (S 78°48'38" W 225.61')

- () = recorded as
- = found iron bar
- = found iron pipe
- ⊙ = 2" iron pipe
- = set iron bar

SCALE 1" = 40'

JOB # 05-262

TAX ID # GLE100018

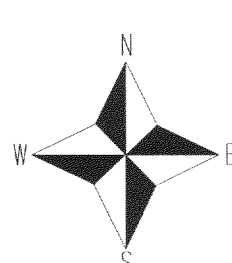

316-1765