

ABERNATHY and ASSOCIATES

Kenneth B. Abernathy Jr.

Wisconsin Registered Land Surveyor

S-1594

W4056 BRAY RD.

ELKHORN, WI. 53121

PHONE: (262) 723-4260 (OFFICE)

(262) 723-7209 (FAX)

Email: abernathy@elknet.net

Plat of Survey

Lot 34 of Baywood Estates
1st Addition located in the NW 1/4
of Section 1 and the NE 1/4 of Section 2
Town 3 North, Range 16 East, Walworth County, Wisconsin

Legend

- Ø FOUND IRON PIPE
- ✕ FOUND IRON ROD
- ⊠ FOUND BRASS CAPPED MONUMENT
- FOUND CONCRETE MONUMENT
- + CHISEL CUT IN CONCRETE
- SET IRON ROD, 24" LONG, WEIGHING 1.5 LBS./LINEAL FT., 3/4" DIA.
- SET IRON ROD, 30" LONG, WEIGHING 4.5 LBS./LINEAL FT., 1-11/16" DIA.
- (x x) RECORDED AS DIMENSION
- x — EXISTING FENCE

Bearings are based
on previous surveys
of record

SCALE: 1" = 50 FEET

"I hereby certify that the above described property has been surveyed by me or under my direction and that the above map is a true representation thereof and shows the size and location of the property, its exterior boundaries, the location of all visible structures and dimensions of all principal buildings thereon, boundary fences, apparent easements, roadways and visible encroachments, if any."

"This survey is made for the use of the present owners of the property, and also those who purchase, mortgage, or guarantee the title thereto within one year from the date hereof."

Kenneth B. Abernathy Jr.

KENNETH B. ABERNATHY, JR.
WISCONSIN REGISTERED LAND SURVEYOR,
S-1594

Date: 3/25/02 Job No. 02.306rev

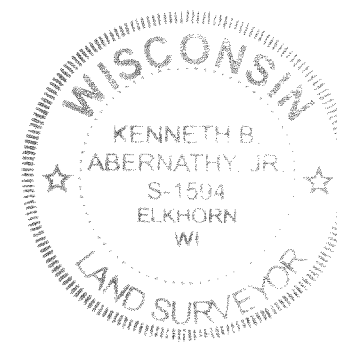

revised 4/15/02
revised 2/26/03

AUG 19 2003

DRS

Briarwood Road

Owners: Ian and Mary Greeley
W5333 Briarwood Rd.
Elkhorn, Wi. 53121

LOT 33

LOT 35

LOT 34

Well
Deck
existing
residence
septic
20,176 sq. ft.
retaining walls
septic vent
old septic vents

Blacktop Driveway

shed

GBEA-11

316-1528