

Plat of Survey

of
Lots 9, 14, and 15 in Block 34 of Interlaken,
 a subdivision located in the East 1/2 of Section 11,
 Town 3 North, Range 16 East, Town of Sugar Creek,
 Walworth County, Wisconsin.

Surveyed for: **Realty Executives**
 4539 Woodgate Drive
 Janesville, Wisconsin. 53546

Note: The proposed house is shown as instructed by the contractor.
 All setbacks must be approved by the building inspector PRIOR
 to construction.

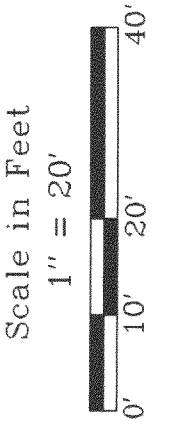
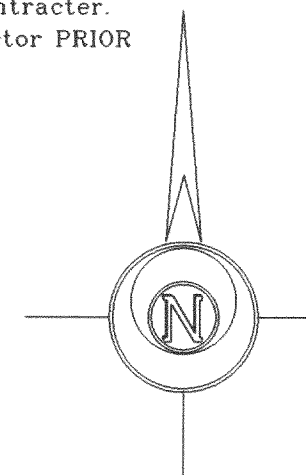

Club House Drive
 (50' Wide)

Juniper Road
 Unimproved
 (50' Wide)

Total Area
 0.275 Acre
 11,974 Sq.Ft.

Proposed House

Copyright © 2003 by Jensen & Olson Land Surveying, LLC.

All rights reserved. No part of this survey plat may be reproduced or transmitted in any form by any means - graphic, electronic, or mechanical, including photocopying, tracing, or information storage and retrieval systems - without permission in writing from Douglas G. Olson, Jensen & Olson Land Surveying, LLC.

I hereby certify that I have surveyed the above described property and the map hereon is correct to the best of my professional knowledge and belief and shows the size and location of the property, its exterior boundaries, the location and dimensions of all visible structures thereon, boundary fences, apparent easements and roadways and visible encroachments, if any.
 This survey is made for the exclusive use of the present owners of property, and also those who purchase, mortgage or guarantee title thereto, within one year from the date hereof.

Douglas G. Olson
 Wisconsin Registered Land Surveyor - 2093

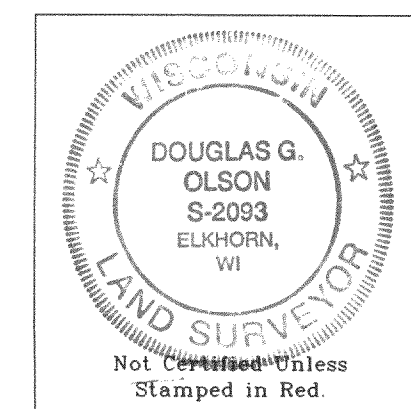
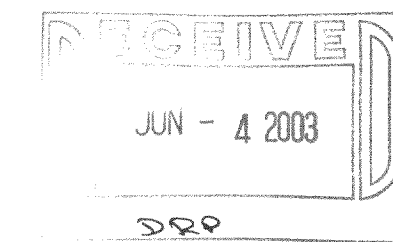

- Notes: 1) This survey plat is not certified unless signed and sealed in red ink.
 2) This survey is subject to Wisconsin lien laws. This Plat of Survey is the notice of intent to file lien. Lien waiver required.

Survey Date: April 29, 2003
 Revisions: No. 1 - Proposed House

Jensen & Olson Land Surveying, LLC
 45 South Wisconsin Street P.O. Box 322
 Elkhorn, Wisconsin 53121
 Telephone (262) 723-3434
 Facsimile (262) 723-8044

- Legend**
- Found Concrete Monument
 - ⊗ Found Iron Pipe
 - Found Iron Rod
 - Set Iron Pipe
 - Recorded Information
 - ⊕ Utility Pedestal
 - ⊖ Gravel Surface
- ⊕ Bearing as shown on prior Survey

Sheet 1 of 1 Sheets
 Job Reference Number
2003.067

2003.067