

ABERNATHY and ASSOCIATES

Kenneth B. Abernathy Jr.

Wisconsin Registered Land Surveyor S-1594

W4056 BRAY RD.
ELKHORN, WI. 53121
PHONE: (262) 723-4260 (OFFICE)
(262) 723-7209 (FAX)
Email: abernathy@elknet.net

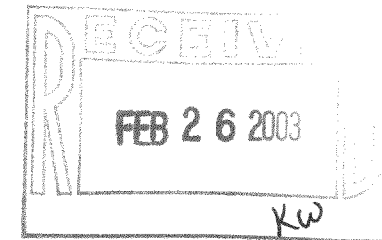

PLAT OF SURVEY

THE NORTH 1/2 OF LOT 37 AND ALL OF LOTS
38 AND 39 OF BLOCK 16, INTERLAKEN SUBDIVISION,
TOWN OF SUGAR CREEK, WALWORTH COUNTY,
WISCONSIN.

NE CORNER BLK. 16

Legend

- ⊗ FOUND IRON PIPE
- FOUND IRON ROD
- ⊠ FOUND BRASS CAPPED MONUMENT
- ⊗ FOUND CONCRETE MONUMENT
- + CHISEL CUT IN CONCRETE
- SET IRON ROD, 24" LONG, WEIGHING 1.5 LBS./LINEAL FT., 3/4" DIA.
- SET IRON ROD, 30" LONG, WEIGHING 4.5 LBS./LINEAL FT., 1-11/16" DIA.
- (x x) RECORDED AS DIMENSION
- x — EXISTING FENCE

Bearings are based on
the west line of Birch
Road assumed to bear
N 0°10'44"E

SCALE: 1" = 30 FEET

"I hereby certify that the above described property has been surveyed by me or under my direction and that the above map is a true representation thereof and shows the size and location of the property, its exterior boundaries, the location of all visible structures and dimensions of all principal buildings thereon, boundary fences, apparent easements, roadways and visible encroachments, if any."
"This survey is made for the use of the present owners of the property, and also those who purchase, mortgage, or guarantee the title thereto within one year from the date hereof."

KENNETH B. ABERNATHY, JR.
WISCONSIN REGISTERED LAND SURVEYOR,
S-1594

Date: Oct. 23, 2002 Job No. 02.1008

NW CORNER BLK. 16

S 89°56'06" E

199.91'

fd. iron pipe
S 89°08'W 0.82'
from true corner

420.00'

fd. iron pipe
S 86°55'W 0.59'
from true corner

100.00'

S 89°46'07" E

39
9981 sq. ft.

N 00°02'35" W
100.00'

14

15

16

conc. and steel wall
to shield burn barrel

fence

(100')

99.61'

37

N 89°46'05" W

S 00°10'44" W
100.00'

38

100.00'

19.99'

25'

50' WIDE

BIRCH ROAD

25'

410.16'

OWNERS: MEL & CAIRE VIRRUETA
N6928 COUNTY ROAD "O"
ELKHORN, WI 53121

BLOCK 16

REVISED TO SHOW PROPOSED RESIDENCE DEC. 13, 2002

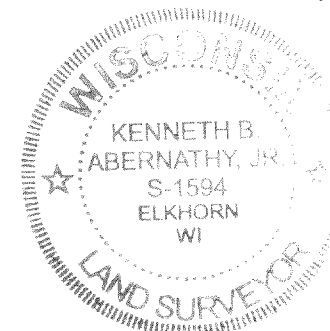

GI-217

316-1454