

ABERNATHY and ASSOCIATES

Kenneth B. Abernathy Jr.

Wisconsin Registered Land Surveyor S-1594

W4056 BRAY RD.
ELKHORN, WI. 53121

PHONE: (262) 723-4260 (OFFICE)
(262) 723-7209 (FAX)

Email: abernathy@elknet.net

PLAT OF SURVEY

Unit 17 of Lauderdale Lakes Estates, A Condominium, Addendum # 1

LOCATED IN PART OF THE SE 1/4 AND THE SW 1/4
OF THE NE 1/4 AND PART OF PART OF THE NW 1/4
OF THE SE 1/4 OF SECTION 1, TOWN 3 NORTH,
RANGE 16 EAST, TOWN OF SUGAR CREEK, WALWORTH
COUNTY, WISCONSIN.

NOTE:

Wood stakes have been placed at the building
corners. builder is to verify dimensions which have
been rounded to the nearest tenth of a foot to insure
proper plan interpretation and contact this office
immediately if any discrepancy exists.

POND COMMON ELEMENT

UNIT 15

UNIT 18

UNIT 16

PROPOSED RESIDENCE

UNIT 17

50,791 sq. ft.

Preplanned Septic
Field 10,010 s.f.

CLEARWATER LANE
66' wide

Owners: Randy and Kristine Breber
N6979 Northwood Dr.
Elkhorn, Wi. 53121

SCALE: 1" = 60 FEET

LEGEND

- FOUND IRON PIPE
- FOUND IRON ROD
- ⊠ FOUND BRASS CAPPED MONUMENT
- FOUND CONCRETE MONUMENT
- + CHISEL CUT IN CONCRETE
- SET IRON ROD, 24" LONG, WEIGHING
1.5 LBS./LINEAL FT., 3/4" DIA.
- SET IRON ROD, 30" LONG, WEIGHING
4.5 LBS./LINEAL FT., 1-11/16" DIA.

(x x x) RECORDED AS DIMENSION

--- EXISTING FENCE

GLLE1-13

PLATTED NORTH

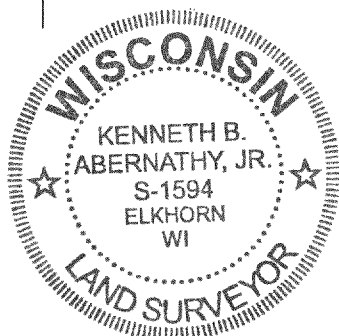

"I hereby certify that the above described
property has been surveyed by me or under my
direction and that the above map is a true
representation thereof and shows the size and
location of the property, its exterior
boundaries, the location of all visible
structures and dimensions of all principal
buildings thereon, boundary fences, apparent
easements, roadways and visible encroachments,
if any."

"This survey is made for the use of the present
owners of the property, and also those who
purchase, mortgage, or guarantee the title
thereto within one year from the date hereof."

Kenneth B. Abernathy, Jr.
KENNETH B. ABERNATHY, JR. S-1594
WISCONSIN REGISTERED LAND SURVEYOR,

DATED July, 19, 2002 Job No. 02.703

316-1382