

ABERNATHY and ASSOCIATES

Kenneth B. Abernathy Jr.

Wisconsin Registered Land Surveyor

S-1594

W4056 BRAY RD.

ELKHORN, WI. 53121

PHONE: (262) 723-4260 (OFFICE)

(262) 723-7209 (FAX)

Email: abernathy@elknet.net

Plat of Survey

Lots 34 and Lot 35 of Baywood Estates
1st Addition located in the NW 1/4
of Section 1 and the NE 1/4 of Section 2
Town 3 North, Range 16 East, Walworth County, Wisconsin

Legend

- Ø FOUND IRON PIPE
- Ø FOUND IRON ROD
- ⊠ FOUND BRASS CAPPED MONUMENT
- FOUND CONCRETE MONUMENT
- + CHISEL CUT IN CONCRETE
- SET IRON ROD, 24" LONG, WEIGHING 1.5 LBS./LINEAL FT., 3/4" DIA.
- SET IRON ROD, 30" LONG, WEIGHING 4.5 LBS./LINEAL FT., 1-11/16" DIA.
- (x x) RECORDED AS DIMENSION
- x — EXISTING FENCE

Bearings are based
on previous surveys
of record

SCALE: 1" = 60 FEET

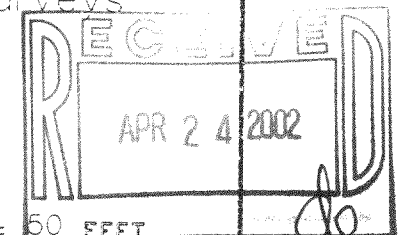
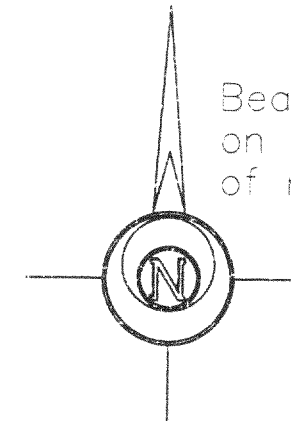

Owners: Ian and Mary Greeley
W5333 Briarwood Rd.
Elkhorn, Wi. 53121

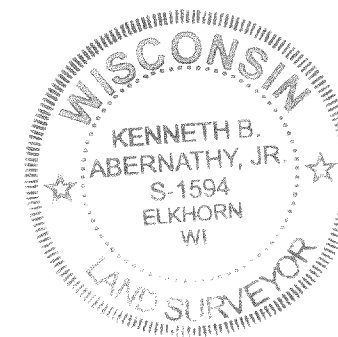

"I hereby certify that the above described property has been surveyed by me or under my direction and that the above map is a true representation thereof and shows the size and location of the property, its exterior boundaries, the location of all visible structures and dimensions of all principal buildings thereon, boundary fences, apparent easements, roadways and visible encroachments, if any."

"This survey is made for the use of the present owners of the property, and also those who purchase, mortgage, or guarantee the title thereto within one year from the date hereof."

Kenneth B. Abernathy, Jr.

KENNETH B. ABERNATHY, JR.
WISCONSIN REGISTERED LAND SURVEYOR,
S-1594

Date: 3/25/02 Job No. 02306

revised 4/15/02

GBEA-12
GBEA-11
316-1361