

PREPARED FOR:
ROB EDWARDS
KEEFE REAL ESTATE, INC.
751 GENEVA PARKWAY
LAKE GENEVA, WI. 53147

PLAT OF SURVEY

-OF-

LOT 4 AND OUTLOT 2, BLUESTEM MEADOWS, BEING PART OF THE SOUTHWEST 1/4 OF THE NORTHEAST 1/4 AND PART OF THE NORTHEAST 1/4 AND SOUTHEAST 1/4 OF THE NORTHWEST 1/4 AND SOUTHEAST 1/4 OF THE NORTHWEST 1/4, PART OF THE NORTHWEST 1/4 OF THE SOUTHEAST 1/4 AND PART OF THE NORTHEAST 1/4 OF THE SOUTHWEST 1/4 OF SECTION 13, TOWN 3 NORTH, RANGE 16 EAST, TOWN OF SUGAR CREEK, WALWORTH COUNTY, WISCONSIN.

LYNCH & ASSOCIATES
ENGINEERING CONSULTANTS, LLC.
405 SKYLINE DRIVE, SUITE C
LAKE GENEVA, WI 53147
(262) 248-3697

C/L BLUESTEM LANE
(66' WIDE)

(N 17°24'34" W)
N 18°03'07" W
44.05' (43.08')
(LCB=N 08°55'52" W)
R=260.88' L=77.19' LC=76.91'
LCB=N 09°34'25" W

(N 0°27'09" W)
N 01°05'42" W
105.26'

12' WIDE UTILITY EASEMENT

BUILDING SETBACK LINE (STAKED)

(S 71°36'14" W)
(S 72°34'40" W)
588.35'

PARK AND OPEN SPACE EASEMENT TO THE EAST OF THIS LINE TO THE EAST LINE OF O.L. 4

HOSE BIBBS AND POSSIBLE SEWER CONNECTIONS

LOT 4
5.32 acres
231563.84 sq ft
TO CREEK C/L

50' WIDE PARK AND OPEN SPACE EASEMENT

- LEGEND**
- FOUND 1" IRON PIPE
 - ⊙ FOUND 2" IRON PIPE
 - SET 5/8" O.D. X 18" IRON BAR 1.13#/L.F.
 - (XX) RECORDED AS
 - ⊠ UTILITY PEDISTAL

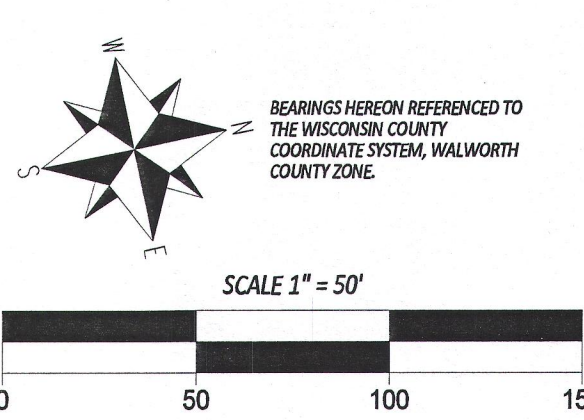

NOTE:
No title commitment or results of a title search were provided to this office pertaining to this survey. This Plat Of Survey may not reflect easements of record, encumbrances, restrictions, ownership, title evidence, or other facts that a current and accurate title search may disclose.

I have surveyed the above-described property and the above map is a true representation thereof and shows the size and location of the property, its exterior boundaries, the location and dimensions of all structures thereon, fences apparent easements and roadways and visible encroachments, if any.

This survey is made for the exclusive use of the present owners of the property, and also those who purchase, mortgage, or insure the title thereto within one (1) year from date hereof; and as to them I warrant the accuracy of said survey map.

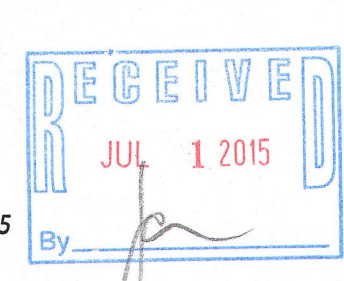

KENNETH B. MEHRING S - 2838
Wisconsin Professional Land Surveyor
(original if signed in rea)

JOB # 15-583
TAX ID # GBM 00004
AND GBM 00013

GBM-4
GBM-13
316-2231