

**ABERNATHY and ASSOCIATES**

**Kenneth B. Abernathy Jr.**

Wisconsin Registered Land Surveyor S-1594

**W4056 BRAY RD.  
ELKHORN, WI. 53121**

**PHONE: (262) 723-4260 (OFFICE)  
(262) 723-7209 (FAX)**

**Email: abernathy@elknet.net**

**PLAT OF SURVEY**

**Unit 17 of Lauderdale Lakes Estates,  
A Condominium, Addendum # 1**

LOCATED IN PART OF THE SE 1/4 AND THE SW 1/4  
OF THE NE 1/4 AND PART OF PART OF THE NW 1/4  
OF THE SE 1/4 OF SECTION 1, TOWN 3 NORTH,  
RANGE 16 EAST, TOWN OF SUGAR CREEK, WALWORTH  
COUNTY, WISCONSIN.

**NOTE:**

Wood stakes have been placed at the building corners, builder is to verify dimensions which have been rounded to the nearest tenth of a foot to insure proper plan interpretation and contact this office immediately if any discrepancy exists.

**POND**  
COMMON ELEMENT

UNIT 15

UNIT 18

UNIT 16

**PROPOSED RESIDENCE**

**UNIT 17**

50,791 sq. ft.

Preplanned Septic  
Field 10,010 s.f.

PROPOSED DRIVEWAY

**CLEARWATER LANE**  
66' wide

Owners: Randy and Kristine Breber  
N6979 Northwood Dr.  
Elkhorn, Wi. 53121

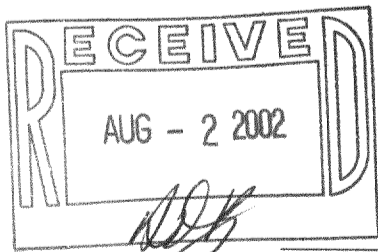

**LEGEND**

- FOUND IRON PIPE
- FOUND IRON ROD
- ⊠ FOUND BRASS CAPPED MONUMENT
- FOUND CONCRETE MONUMENT
- + CHISEL CUT IN CONCRETE
- SET IRON ROD, 24" LONG, WEIGHING 1.5 LBS./LINEAL FT., 3/4" DIA.
- SET IRON ROD, 30" LONG, WEIGHING 4.5 LBS./LINEAL FT., 1-11/16" DIA.

( x x x ) RECORDED AS DIMENSION

\* \* \* \* \* EXISTING FENCE

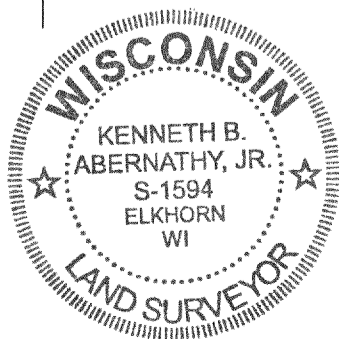
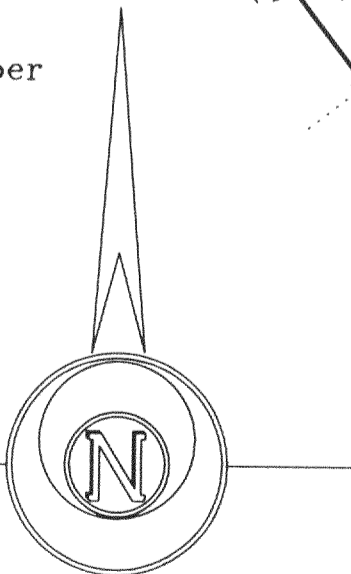

**SCALE: 1" = 60 FEET**

"I hereby certify that the above described property has been surveyed by me or under my direction and that the above map is a true representation thereof and shows the size and location of the property, its exterior boundaries, the location of all visible structures and dimensions of all principal buildings thereon, boundary fences, apparent easements, roadways and visible encroachments, if any."  
"This survey is made for the use of the present owners of the property, and also those who purchase, mortgage, or guarantee the title thereto within one year from the date hereof."

*Kenneth B. Abernathy Jr.*  
**KENNETH B. ABERNATHY, JR. S-1594  
WISCONSIN REGISTERED LAND SURVEYOR,**

DATED July, 19, 2002 Job No. 02.703

316-1382

GLLE1-13