

West 1/4 Corner  
Section 9-3-15.

Lake

Lorraine

# Plat of Survey

of

**Lots 1 and 2 of Block 1 of Skansen First Addition,**

a subdivision located in the Southwest 1/4 of Section 9, Town 3 North,  
Range 15 East, Town of Richmond, Walworth County, Wisconsin.

Surveyed for: **Bill Waring**  
2152 West Wilson Avenue  
Chicago, Illinois. 60625

Tax Parcel  
CR 800009

Reset Posey Pin  
with Iron Rod  
1-3/16" dia.

(N64°50'W)  
S65°03'58"E  
49.81'  
(50')

Reset Posey Pin  
with Iron Rod  
3/4" dia.

(N64°50'W)  
S64°59'14"E  
49.40'  
(50')

**Tax Parcel  
CSA 00001**

0.247 Acres  
10,767 Sq.Ft.

Lot 1

Lot 2

Lot 3

Lot 4

B l o c k  
1

Lake Road

Lot 34

Lot 33

Lot 32

B l o c k  
4

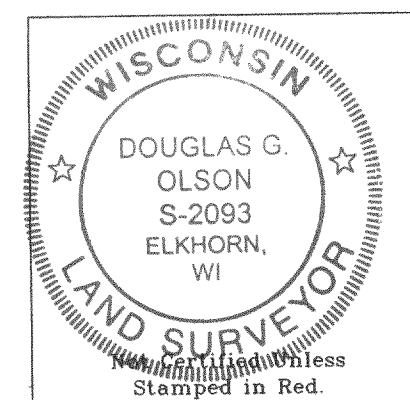
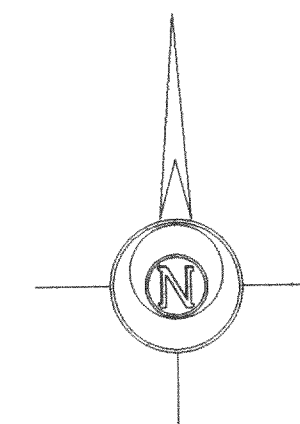

Notes: 1) This survey plat is not  
certified unless signed  
and sealed in red ink.

2) This survey is subject to Wisconsin lien laws.  
This Plat of Survey is the notice of intent  
to file lien. Lien waiver required.

RECEIVED OF:

MAY 11 2006  
SMF

Copyright © 2005 by Jensen & Olson Land Surveying, LLC.

All rights reserved. No part of this survey plat may be reproduced  
or transmitted in any form by any means - graphic, electronic, or  
mechanical, including photocopying, tracing, or information storage  
and retrieval systems - without permission in writing from Douglas  
G. Olson, Jensen & Olson Land Surveying, LLC.

I hereby certify that I have surveyed the above described  
property and the map hereon is correct to the best of my professional  
knowledge and belief and shows the size and location of the property,  
its exterior boundaries, the location and dimensions of all visible  
structures thereon, boundary fences, apparent easements and roadways  
and visible encroachments, if any.  
This survey is made for the exclusive use of the present owners  
of property, and also those who purchase, mortgage or guarantee title  
thereto, within one year from the date hereof.

Douglas G. Olson  
Wisconsin Registered Land Surveyor - 2093

Survey Date: March 28, 2005

Revisions:

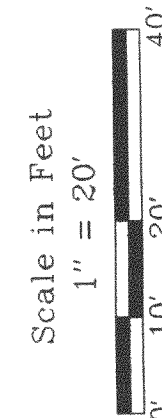

**Jensen & Olson Land Surveying, LLC**

45 South Wisconsin Street P.O. Box 322  
Elkhorn, Wisconsin. 53121  
Telephone (262) 723-3434  
Facsimile (262) 723-8044

Legend  
Found County Section Corner  
Found Concrete Monument  
Found Iron Pipe  
Found Iron Rod  
Found Posey Pine  
Found P.K. Nail  
Recorded Information

Sheet 1 of 1 Sheets

Job Reference Number  
**2005.023**

2005.023

CSA-1

315-963