

TOPOGRAPHIC SURVEY

LOT 5 OF CLIFF'S VIEW SUBDIVISION

LOCATED IN PART OF THE NE 1/4 AND NW 1/4 OF THE NW 1/4 OF SECTION 3,
TOWN 3 NORTH, RANGE 15 EAST, WALWORTH COUNTY, WISCONSIN

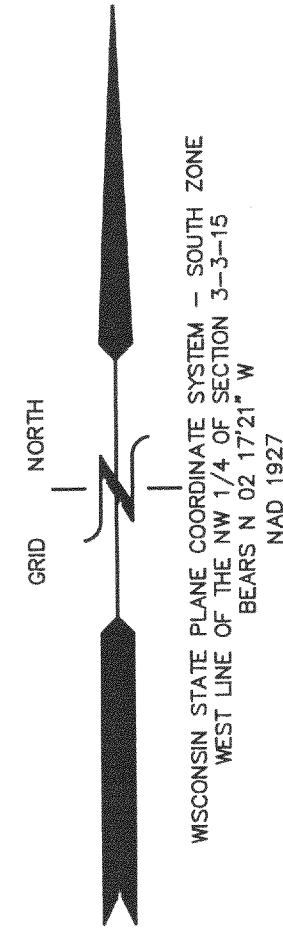

- LEGEND**
- = FOUND IRON PIPE STAKE, 1 3/8" O.D.
 - = FOUND IRON REBAR STAKE, 3/4" DIA.
 - = FOUND CONCRETE COUNTY MONUMENT W/ BRASS CAP
 - = SET SOLID ROUND IRON BAR STAKE, 1 5/16" x 30" x 4.60 lbs./ft.
 - {XXX} = RECORDED AS
- ALL OTHER LOTS AND OUTLOT CORNERS ARE SET IRON REBAR STAKES, 3/4"x24"x1.50 lbs./ft. DISTANCES SHOWN ALONG THE CURVES REPRESENT ARC DISTANCES
- = SLOPES 12% OR GREATER
- LANDS SUBJECT TO CHAPTER 2.9 WALWORTH COUNTY SHORELAND ZONING ORDINANCE RESTRICTIONS
- DISTANCES SHOWN ALONG THE CURVES REPRESENT ARC DISTANCES

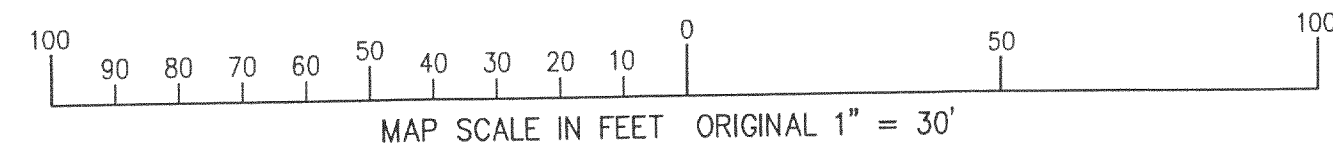

UNPLATTED LANDS

UNPLATTED LANDS

UNPLATTED LANDS

UNPLATTED LANDS

UNPLATTED LANDS



NOTE: COPIES OF THIS MAP TO WHICH THE FOLLOWING CERTIFICATE WILL APPLY SHOW THE SURVEYOR'S ORIGINAL SEAL AND SIGNATURE IN RED INK. COPIES BY ANY OTHER MEANS MAY HAVE ALTERATIONS WHICH DO NOT REPRESENT THE SURVEYOR'S WORK PRODUCT.

I HEREBY CERTIFY THAT THE ABOVE DESCRIBED PROPERTY HAS BEEN SURVEYED UNDER MY DIRECTION AND THAT THE ABOVE MAP IS A TRUE REPRESENTATION THEREOF AND SHOWS THE SIZE AND LOCATION OF THE PROPERTY AND ITS EXTERIOR BOUNDARIES. THIS SURVEY IS MADE FOR THE USE OF THE PRESENT OWNERS OF THE PROPERTY, AND ALSO THOSE WHO PURCHASE, MORTGAGE, OR GUARANTEE THE TITLE THERETO WITHIN ONE YEAR FROM THE DATE HEREOF.

DATED: OCTOBER 7, 2005

PETER S. GORDON R.L.S. 2101

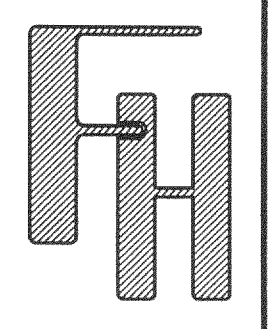
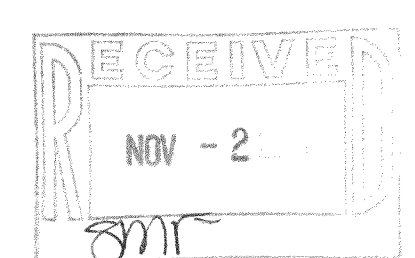
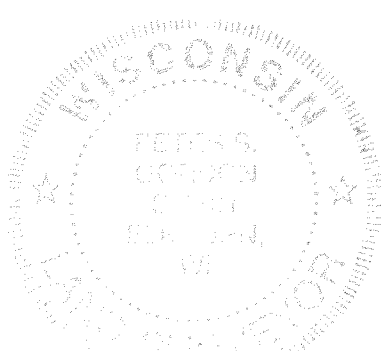

WORK ORDERED BY -
VICTORIA GOULETAS
3300 NORTH LAKE SHORE DRIVE, APT. 2C
CHICAGO, IL 60657

FARRIS, HANSEN & ASSOCIATES, INC.
ENGINEERING - ARCHITECTURE - SURVEYING
7 RIDGWAY COURT P.O. BOX 437
ELKHORN, WISCONSIN 53121
OFFICE: (262) 723-2098 FAX: (262) 723-5886

REVISIONS

PROJECT NO.
6189.5
DATE
10-24-2005
SHEET NO.
1 OF 1

CCV00005

315-936