

LAND-MARK SURVEYING

Mark L. Miritz
Wisconsin Registered Land Surveyor S-2582

N9330 Knuteson Drive
Whitewater, WI 53190
Phone: (262) 495-3284

PLAT OF SURVEY

LOT 10 OF LORWOOD ACRES SUBDIVISION, LOCATED IN
PART OF THE NORTHWEST 1/4 OF THE NE 1/4 OF SECTION 2,
TOWN 3 NORTH, RANGE 15 EAST, RICHMOND TOWNSHIP,
WALWORTH COUNTY, WISCONSIN.

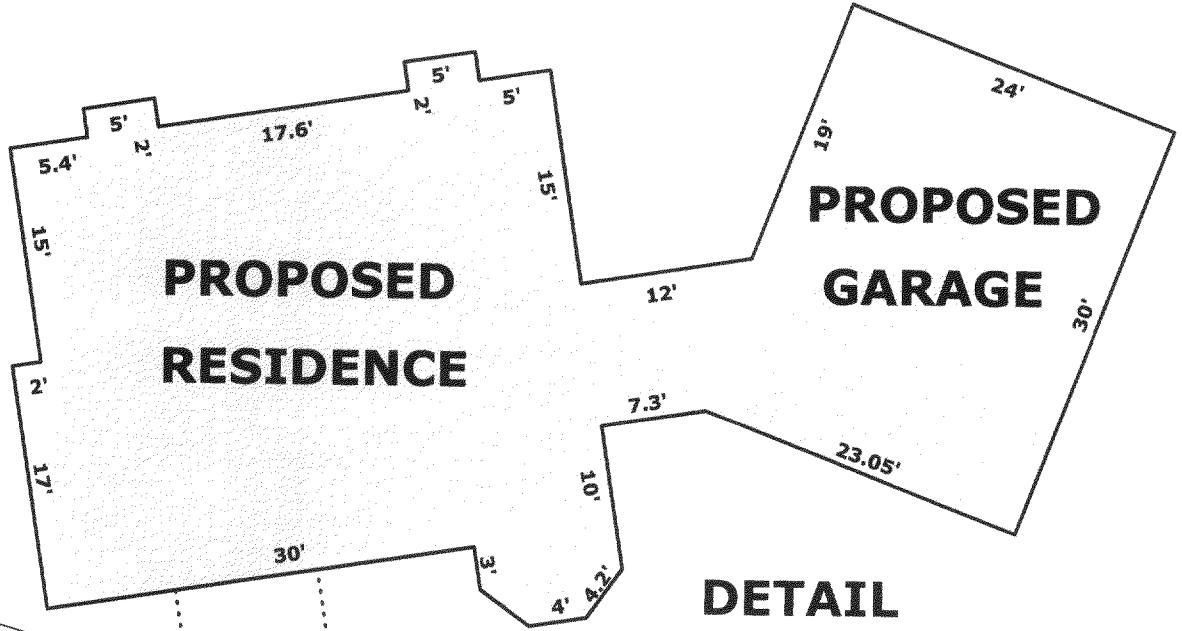
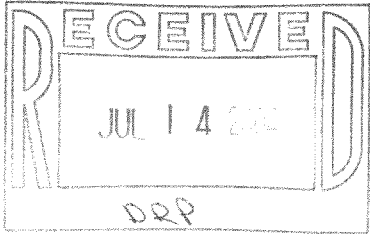

SEE BUILDERS PLANS FOR FURTHER DETAILS

LORWOOD DRIVE

CH=S 81°36'22" E 36.28'
R=583.00'
L=36.29'
S 83°23'21" E 133.95'

12' WIDE UTILITY EASEMENT

CH=S 59°39'22" E 236.66'
R=294.00'
L=243.57'

ORDERED BY: WALTON ENTERPRISES, INC.
ROSS WALTON
W3442 VANNOY DRIVE
WHITEWATER, WI 53190

CLIENT REFERENCE: SOTHERLAND

SEE DETAIL

PROPOSED DRIVE

LIMITED BUILDING AREA
(AS PLATTED)

LOT 10

229,478 SQ. FT.
5.27 ACRES

N 03°54'02" W 726.88'

EASEMENT FOR DRAINAGE AND NATURAL AREA

LOT 11

LOT 7

S 01°51'53" E 354.48'

S 87°04'41" W 300.00'

LOT 9

LEGEND

- FOUND IRON PIPE
- FOUND IRON ROD
- FOUND COUNTY MONUMENT
- FOUND CONCRETE MONUMENT
- CHISEL CUT IN CONCRETE
- SET IRON ROD, 24" LONG, WEIGHING 1.5 LBS./LINEAL FT., 3/4" DIA.
- RECORDED AS DIMENSION
- EXISTING FENCE

SCALE: 1" = 80 FEET

"I hereby certify that the above described property has been surveyed by me or under my direction and that the above map is a true representation thereof and shows the size and location of the property, its exterior boundaries, the location of all visible structures and dimensions of all principal buildings thereon, boundary fences, apparent easements, roadways and visible encroachments, if any."
"This survey is made for the use of the present owners of the property, and also those who purchase, mortgage, or guarantee the title thereto within one year from date hereof."



MARK L. MIRITZ
WISCONSIN REGISTERED
LAND SURVEYOR S-2582

DATE: APRIL 8, 2004

JOB NO. 04.404

CLOR 00010

315-860