

ABERNATHY and ASSOCIATES

Kenneth B. Abernathy Jr.

Wisconsin Registered Land Surveyor S-1594

W4056 BRAY RD.

ELKHORN, WI. 53121

PHONE: (262) 723-4260 (OFFICE)

(262) 723-7209 (FAX)

Email: abernathy@elknet.net

PLAT OF SURVEY

LOT 3 OF CERTIFIED SURVEY MAP NO. 2143, LOCATED IN THE NORTHEAST 1/4 OF THE SOUTHWEST 1/4 OF SECTION 12, TOWN 3 NORTH, RANGE 15 EAST, RICHMOND TOWNSHIP, WALWORTH COUNTY, WISCONSIN.

LOT 20
MEADOWWOOD SUBDIVISION

LOT 2

ORDERED BY:
SCHAUDER BUILDING, INC.
4115 HIGHWAY 51 NORTH
JANESVILLE, WISCONSIN
53545-9674

OWNERS:
ROBERT & JANET SWANSON

LOT 3
100,025 SQ. FT.

UNDERGROUND UTILITY BOXES

S 0°11'05" E 463.93'

S 89°48'55" W 215.70'

NO ACCESS TO COUNTY TRUNK HIGHWAY "P"

N 0°11'05" W 463.53'

NO ACCESS TO COUNTY TRUNK HIGHWAY "P"

COUNTY TRUNK HIGHWAY "P"
66' WIDE

PROPOSED DRIVEWAY
PROPOSED RESIDENCE

10' UTILITY EASEMENT

N 89°42'38" E 215.70'

ANDERSON DRIVE

66' WIDE

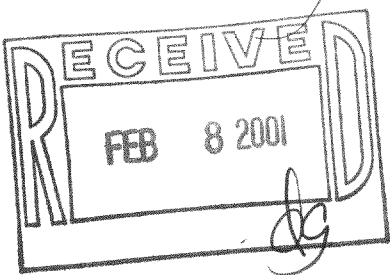

REVISED 12-26-2000

SCALE: 1"= 60 FEET

Legend

- FOUND IRON PIPE
- FOUND IRON ROD
- FOUND BRASS CAPPED MONUMENT
- * FOUND CONCRETE MONUMENT
- + CHISEL CUT IN CONCRETE
- SET IRON ROD, 24" LONG, WEIGHING 1.5 LBS./LINEAL FT., 3/4" DIA.
- SET IRON ROD, 30" LONG, WEIGHING 4.5 LBS./LINEAL FT., 1-11/16" DIA.
- (xx) RECORDED AS DIMENSION
- x-x- EXISTING FENCE

NOTE
WOOD STAKES HAVE BEEN PLACED AT BUILDING CORNERS. BUILDER IS TO VERIFY DIMENSIONS WHICH HAVE BEEN ROUNDED TO THE NEAREST TENTH OF A FOOT TO INSURE PROPER PLAN INTERPRETATION AND CONTACT THIS OFFICE IMMEDIATELY IF ANY DISCREPANCY EXISTS.

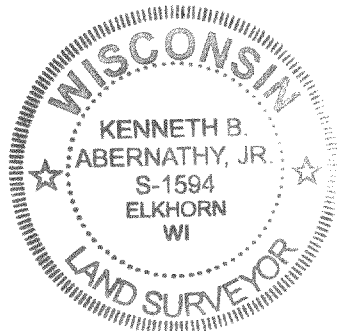

"I hereby certify that the above described property has been surveyed by me or under my direction and that the above map is a true representation thereof and shows the size and location of the property, its exterior boundaries, the location of all visible structures and dimensions of all principal buildings thereon, boundary fences, apparent easements, roadways and visible encroachments, if any."

"This survey is made for the use of the present owners of the property, and also those who purchase, mortgage, or guarantee the title thereto within one year from date hereof."

Kenneth B. Abernathy, Jr.
KENNETH B. ABERNATHY, JR.
WISCONSIN REGISTERED LAND SURVEYOR,
S-1594

Date: DEC. 7, 2000 Job No. 00.1104