

of

Also

106 East Walworth Avenue
Delavan, Wisconsin. 53115

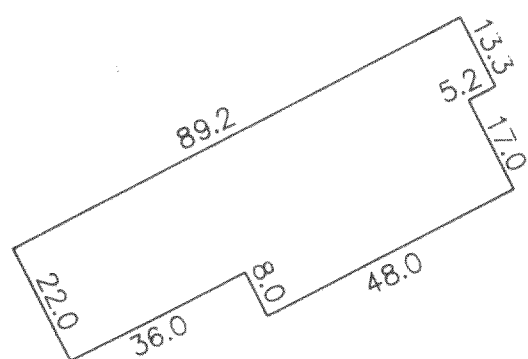

Poured Concrete Foundation

Frame Walls Under Construction

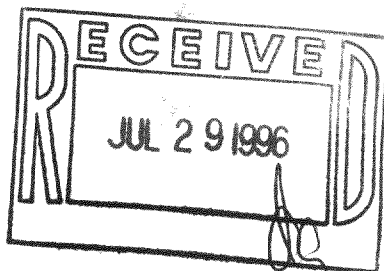
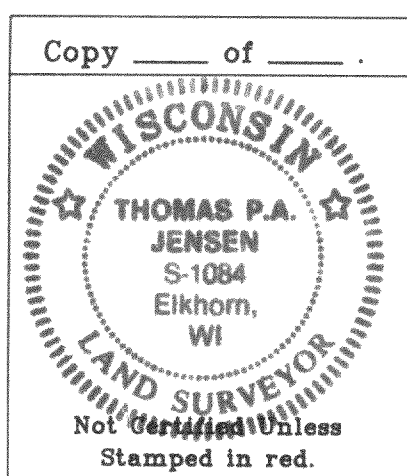

Copyright c 1994 by Jensen Surveying & Mapping S.C.

All rights reserved. No part of this survey plat may be reproduced or transmitted in any form by any means – graphic, electronic, or mechanical, including photocopying, tracing, or information storage and retrieval systems – without permission in writing from Thomas P.A. Jensen, Jensen Surveying & Mapping S.C..

I, Thomas P.A. Jensen, Wisconsin Registered Land Surveyor, do hereby certify that this survey was performed by me, or under my direction in full compliance with the owner's / agent's instructions and Chapter A-E 7 of the Wisconsin Administrative Code "Minimum Standards for Property Surveys"; and that this map is as accurate representation thereof to the best of my knowledge and belief.

Note: This survey plat is not
certified unless signed
and sealed in red ink.

Thomas P.A. Jensen R.L.S. 1084

Sheet 1 of 1 Sheets.

Legend

- Found County Monument
 ✕ Found iron rod
 () Recorded as dimension
 ★ Soil Boring

Job Reference Number
1993.110

45 South Wisconsin Street P.O. Box 322
Elkhorn, Wisconsin. 53121
Telephone & Facsimile: (414) 723-3434

Scale in Feet

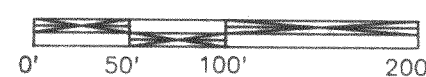
$$1'' = 100'$$

Mapping date: Feb. 28, 1994.

Revisions: May 3, 1994.

1993.110 x

CA-2147-1
315-536