

PLAT OF SURVEY

Lot 2 of Certified Survey Map Number 1842, located in the Northwest 1/4 of the Northwest 1/4 of Section 10 and the Northeast 1/4 of the Northeast 1/4 of Section 9, Town 3 North, Range 15 East, Town of Richmond, Walworth County, Wisconsin.

Excepting therefrom that portion of the Roadway Easement dedicated in Volume 628, Page 2292 of Deeds as Document Number 277054.

Lot 1

Lot 2

5.52 Acres ±

Owners: Scott D. & Cozette M. Moffatt
701 Ridge Street
Algonquin, Illinois 60102

Proposed Dwelling

Hunter's Ridge Road
66' Wide
DEDICATED TO THE PUBLIC
VOLUME 628, PAGE 2292, DOCUMENT #277054



Legend

- FOUND IRON PIPE
- FOUND IRON ROD
- FOUND BRASS CAPPED MONUMENT
- FOUND CONCRETE MONUMENT
- CHISEL CUT IN CONCRETE
- SET IRON ROD, 24" LONG, WEIGHING 1.5 LBS. LINEAL FT., 3/4" DIA.
- SET IRON ROD, 30" LONG, WEIGHING 4.5 LBS. LINEAL FT., 1-11/16" DIA.
- RECORDED AS DIMENSION
- EXISTING FENCE

SCALE: 1" = 30 FEET

I hereby certify that the above described property has been surveyed by me or under my direction and that the above map is a true representation thereof and shows the size and location of the property, its exterior boundaries, the location of all visible structures and dimensions of all principal buildings thereon, boundary fences, apparent easements, roadways and visible encroachments, if any. This survey is made for the use of the present owners of the property, and also those who purchase, mortgage, or guarantee the title thereto within one year from date hereof.

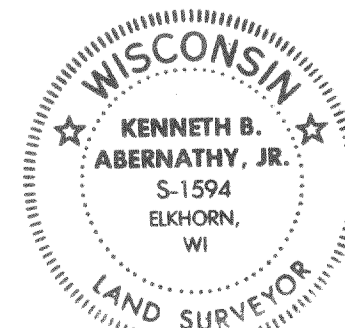

Kenneth B. Abernathy, Jr.
KENNETH B. ABERNATHY, JR.
WISCONSIN REGISTERED LAND SURVEYOR,
S-1594

Date: July 12, 1995 Job No. 1995.627

1A-1842-2

315-493