

PLAT OF SURVEY OF

SEVEN PARCELS OF LAND LOCATED IN THE SOUTHWEST
 1/4 OF SECTION 36, T4N, R15E AND THE NORTHWEST 1/4
 OF SECTION 1, T3N, R15E, WALWORTH COUNTY, WISCONSIN.

LOCATION DRAWING
 SECTION 36, T4N, R15E
 SECTION 1, T3N, R15E
 WALWORTH COUNTY, WISCONSIN

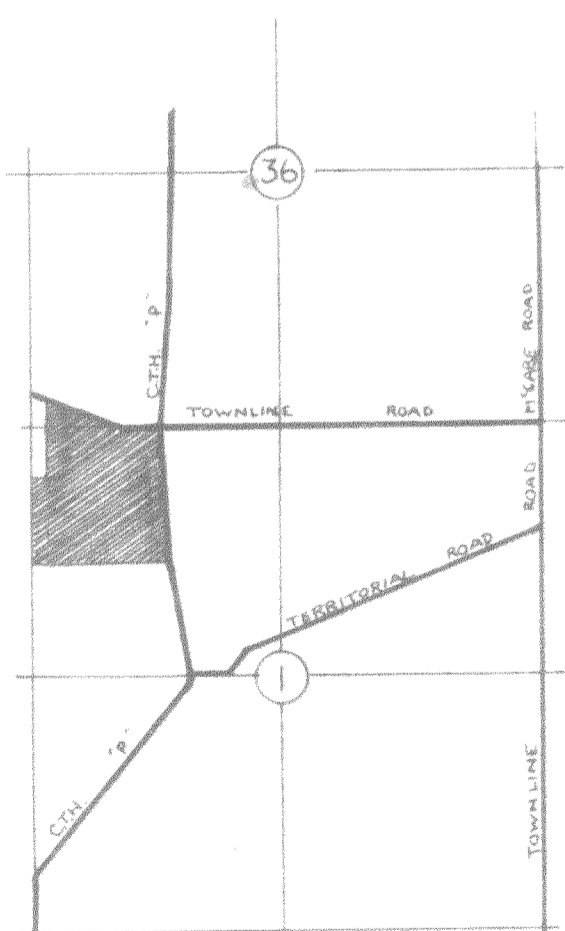

SCALE: 1" = 2000'

SCALE: 1" = 100'

LEGEND
 ○ - IRON PIPE SET
 ■ - CONCRETE MONUMENT
 ZONED A-2 and C-2

I, EUGENE A. BLOMQUIST, DO HEREBY CERTIFY THAT I
 HAVE SURVEYED THE PROPERTY HEREON DESCRIBED
 ACCORDING TO THE OFFICIAL RECORDS, AND THAT THE
 PLAT HEREON IS A CORRECT REPRESENTATION OF
 THE LOT LINES.

Eugene A. Blomquist
 EUGENE A. BLOMQUIST
 WISCONSIN REGISTERED LAND SURVEYOR, S 1279

DATE: Aug 29, 1979

HAROLD H. KOLB
REGISTERED PROFESSIONAL LAND SURVEYOR
LAKE GENEVA, WISCONSIN

DESCRIPTIONS OF

Seven parcels of land located in the Southwest 1/4 of Section 36, T4N, R15E,
and the Northwest 1/4 of Section 1, T43N, R15E, Walworth County, Wisconsin.

Parcel 1
Commencing at the Northwest corner of said Section 1; thence S0°10'10"E 511.50
feet to the place of beginning; thence S89°38'10"E 90.75 feet; thence along the
arc of a curve to the left, the radius being 150.00 feet, and the chord bearing
S22°38'10"E 114.80 feet; thence S44°38'10"E 279.89 feet; thence along the arc of
a curve to the left the radius being 60.00 feet and the chord bearing S37°41'55"E
71.57 feet; thence S22°37'25"W 523.13 feet; thence S89°26'20"W 180.00 feet; thence
N°10'10"W 861.95 feet to the place of beginning. Containing 5.01 Acres.

Parcel 2
Commencing at the Northwest corner of said Section 1; thence S0°10'10"E 1373.46
feet; thence S89°26'20"E 180.00 feet to the place of beginning; thence N22°57'25"E
523.13 feet; thence along the arc of a curve to the left the radius being 60.00
feet and the chord bearing N46°13'10"E 86.76 feet; thence S70°22'20"E 332.65 feet;
thence S4°46'55"W 426.05 feet; thence S89°26'20"W 544.60 feet to the place of
beginning. Containing 5.12 Acres.

Parcel 3
Commencing at the Northwest corner of said Section 1; thence S0°10'10"E 1373.46
feet; thence N0°26'20"E 724.60 feet to the place of beginning; thence N4°46'55"E
426.05 feet; thence N89°26'20"E 516.34 feet; thence S4°46'55"W 99.60 feet; thence
along the arc of a curve to the left the radius being 601.70 feet, and the chord
bearing S2°15'25"W 323.74 feet; thence S89°26'20"W 525.34 feet to the place of
beginning. Containing 5.05 Acres.

Parcel 4
Commencing at the Northwest corner of said Section 1; thence S0°10'10"E 1373.46
feet; thence N22°26'20"E 1249.94 feet; thence along the arc of a curve to the
right the radius being 5015.70 feet, and the chord bearing N3°14'26"E 325.74 feet;
thence N4°46'55"E 99.60 feet to the place of beginning; thence S89°26'20"W 516.34
feet; thence N70°22'20"W 170.00 feet; thence N5°30'45"E 801.89 feet; thence S 6°57'40"E
618.57 feet; thence S11°28'45"E 162.75 feet; thence S7°17'00"E 135.35 feet; thence
S4°46'55"W 325.34 feet to the place of beginning. Containing 7.50 Acres.

Parcel 5
Commencing at the Northwest corner of said Section 1; thence S89°38'10"E 156.75
feet; thence N0°43'30"E 250.23 feet; thence S69°58'05"E 591.16 feet to the place
of beginning; thence S72°57'40"E 136.44 feet; thence S88°56'15"E 226.77 feet; thence
S 7°21'50"W 174.11 feet; thence S 8°39'38"10"E 206.11 feet; thence S 8°41'50"W 146.80
feet; thence S 26°55'40"W 678.51 feet; thence N 5°30'45"E 128.72 feet; thence
N 7°12'50"E 475.00 feet; thence N 18°38'05"E 33.01 feet to the place of beginning.
Containing 5.49 acres.

Parcel 6
Commencing at the Northwest corner of said Section 1; thence S89°38'10"E 156.75
feet to the place of beginning; thence N0°43'30"E 250.23 feet; thence S69°58'05"E
591.16 feet; thence S18°34'05"W 33.01 feet; thence S7°12'50"W 475.00 feet; thence
N6°14'25"W 597.27 feet; thence N0°10'10"W 123.48 feet to the place of beginning.
Containing 5.04 Acres.

Parcel 7
Commencing at the Northwest corner of said Section 1; thence S89°38'10"E 156.75
feet; thence S0°10'10"E 128.48 feet to the place of beginning; thence S56°14'28"E
587.37 feet; thence S7°30'45"W 430.81 feet; thence N70°22'20"W 162.65 feet; thence
along the arc of a curve to the left the radius being 60.00 feet and the chord
bearing N50°38'05"W 92.77 feet; thence N44°38'10"W 279.89 feet; thence along the
arc of a curve to the right the radius being 60.00 feet and the chord bearing
N22°08'10"W 64.20 feet; thence N0°10'10"W 385.01 feet to the place of beginning.
Containing 5.01 Acres.

LEGEND

- ⊕ - IRON PIPE FOUND
- - IRON PIPE PLACED
- - CONCRETE MONUMENT
- x - SPIKE

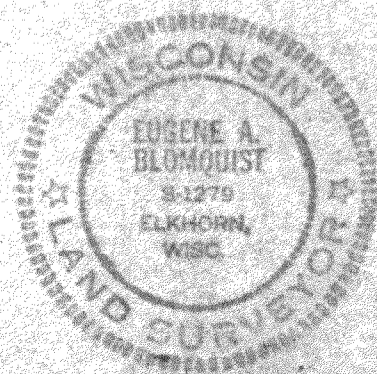

I, EUGENE BLONQUIST, DO HEREBY CERTIFY THAT I HAVE
SURVEYED THE PROPERTY HEREON DESCRIBED ACCORDING
TO THE OFFICIAL RECORDS AND THAT THE PLAT HEREON
IS A CORRECT REPRESENTATION OF THE LOT LINES.

Eugene A. Blomquist
EUGENE A. BLONQUIST
WISCONSIN REGISTERED LAND SURVEYOR, S-1279
DATE Aug 29 1978