

# Plat of Survey

of

## Lot 11 in Block 1 of Richmond Heights,

a subdivision located in the Southeast 1/4 of Section 3, Town 3 North,  
Range 15 East, Town of Richmond, Walworth County, Wisconsin.

Surveyed for: **Keefe Real Estate, Inc.**

751 Geneva Parkway \* P.O. Box 460  
Lake Geneva, Wisconsin. 53147

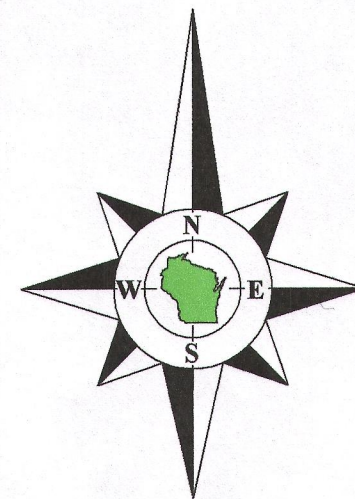

Bearings reference to the  
plat of Richmond Heights.

**Oakwood Drive**  
(50' Wide)

**Lot 11**  
**Tax Parcel**  
**CRH 00011**  
0.255 Acre  
11,107 Sq.Ft.

**House**  
N7034

**Deck**

**Shed**

**Well**

**Upper Level Deck**

**Porch**

**Stone**

Lot 10

Lot 34

Lot 33

Lot 32

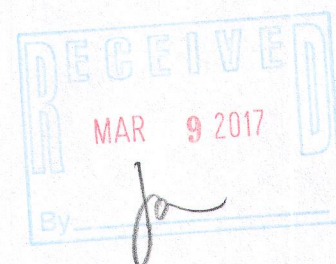

Copyright 2016 by Olson Land Surveying, LLC.

All rights reserved. No part of this survey plat may be reproduced or transmitted in any form by any means - graphic, electronic, or mechanical, including photocopying, tracing, or information storage and retrieval systems - without permission in writing from Douglas G. Olson, Olson Land Surveying, LLC.

I hereby certify that I have surveyed the above described property and the map hereon is correct to the best of my professional knowledge and belief and shows the size and location of the property, its exterior boundaries, the location and dimensions of all visible structures thereon, boundary fences, apparent easements and roadways and visible encroachments, if any.

This survey is made for the exclusive use of the present owners of the property, and also those who purchase, mortgage or guarantee title thereto, within one year from the date hereof.

Douglas G. Olson  
Wisconsin Professional Land Surveyor - 2093

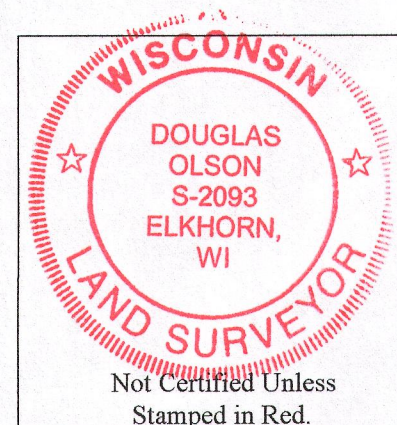

### Notes:

- 1) This survey plat is not certified unless signed and sealed in red ink.
- 2) This survey is subject to Wisconsin lien laws. This Plat of Survey is the notice of intent to file lien. Lien waiver required.

CRH-11 315-1290

Survey Date: July 19, 2016.  
Revisions:

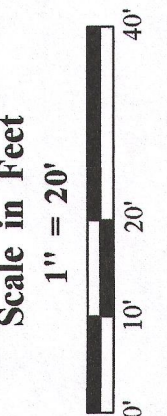

**Olson Land Surveying, LLC**



45 South Wisconsin Street \* P.O. Box 322 \* Elkhorn, Wisconsin. 53121  
Telephone: (262) 723-3434 \* Facsimile: (262) 723-8044  
Email: doug@olsonsurveying.com

**Legend**  
Found Iron Pipe 1" dia.  
Set Iron Pipe 1" dia.  
Recorded Information  
Utility Pole  
Concrete Cover  
Septic Vent  
Asphalt Surface  
Concrete Surface  
Gravel

Sheet 1 of 1 Sheets  
Drawing Name  
Job Reference Number  
2016.079

2016.079