

Plat of Survey

of
Lots 1 & 2 of Certified Survey Map No. 4639,
 recorded in Vol. 30 of Certified Survey Maps of Walworth County on Page
 263 and located in the Northeast 1/4 of Section 17, Town 3 North, Range 15
 East, Town of Richmond, Walworth County, Wisconsin.

Surveyed for: **Patricia Brockwell**
 N6398 State Road 89
 Delavan, Wisconsin. 53115
 &
Jeremy & Kelly Brockwell
 N6398 State Road 89
 Delavan, Wisconsin. 53115



Bearings reference to the Wisconsin State
 Plane Coordinate System, South Zone.

Detail
 1"=30'

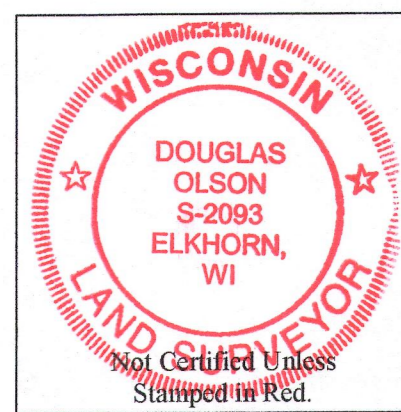
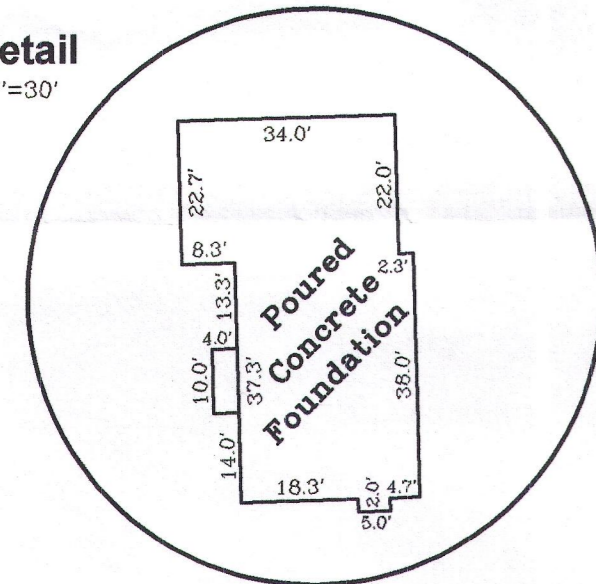

Notes:

- 1) This survey plat is not certified unless signed and sealed in red ink.
- 2) This survey is subject to Wisconsin lien laws. This Plat of Survey is the notice of intent to file lien. Lien waiver required.

Note A:

This Plat of Survey is a retracement of Lot 2 of Certified Survey Map No. 2478, surveyed by David F. Abell June 28, 1994. The North line of said Lot 2 is identified as the North line of the Southwest 1/4 of the Northeast 1/4 of Section 17-3-15 on said C.S.M. 2478. The bearing shown on said C.S.M. on this line matches the bearing shown on the North line of Lot 1 of C.S.M. 3794 which is also a section subdivision of the Northeast 1/4 of Section 17-3-15.

Tax Parcel CR 1700006, which is North of C.S.M. 2478, was surveyed in November 1967 by George Dunham and his pipe are shown. David F. Abell did not use these pipe to establish the North line of C.S.M. 2478. Dunham's pipe is 2.30' South of the iron rod at the Northeast corner of C.S.M. 2478. Extending the line of Dunham's pipe West to the West line of the Northeast 1/4 of Section 17-3-15 Dunham's point is 1.25' North of the point established by C.S.M. 2478.

Copyright 2015 by Olson Land Surveying, LLC.

All rights reserved. No part of this survey plat may be reproduced or transmitted in any form by any means - graphic, electronic, or mechanical, including photocopying, tracing, or information storage and retrieval systems - without permission in writing from Douglas G. Olson, Olson Land Surveying, LLC.

I, Douglas G. Olson, Wisconsin Professional Land Surveyor, do hereby certify that this survey was performed by me, or under my direction in full compliance with the owner's/agent's instructions and Chapter A-E 7 of the Wisconsin Administrative Code "Minimum Standards for Property Surveys"; and that this map is an accurate representation thereof to the best of my knowledge and belief.

Douglas G. Olson
 Wisconsin Professional Land Surveyor - 2093

North 1/4 Corner
 Section 17-3-15
 N 266.88479
 E 2.33606778

Center 1/4 Corner
 Section 17-3-15
 N 264.34446
 E 2.33614058

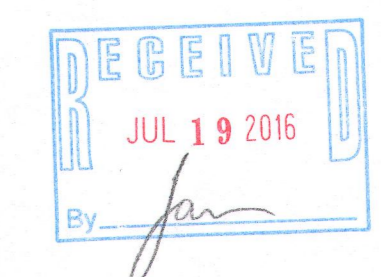

CA4639-1 CA4639-2 315-1977

Survey date: August 14, 2015.
 REVISIONS:
 No. 1 - Proposed House
 No. 2 - P.O. Box 322 * Elkhorn, Wisconsin. 53121
 Location moved
 No. 3 - Poured Concrete
 No. 4 - Recorded CSM



Olson Land Surveying, LLC
 45 South Wisconsin Street * P.O. Box 322 * Elkhorn, Wisconsin. 53121
 Telephone: (262) 723-3434 * Facsimile: (262) 723-8044
 Email: doug@olsonsurveying.com

Legend
 Found County Section Corner
 Found Iron Pipe, 7/8" dia.
 Found Iron Pipe, 1" dia.
 Recorded Information
 Soil Boring
 Septic Vent
 Concrete Surface
 Gravel Surface

Sheet 1 of 1 Sheets
 Job Reference Number
 2015.076
 2015.076