

County Line Road

West 1/4 Corner
Section 19-3-15
N. 258,916.69
E. 2,328,569.35

(N1°39'28"W 2840.14') State Plane
N1°39'28"W 2840.34'
West line of the Southwest 1/4 of Section 19-3-15
1158.04'

(66' Wide)

N1°39'28"W 298.00'

Rock County
Walworth County

1184.30'

Southwest Corner
Section 19-3-15
N. 256,277.76
E. 2,328,665.72

Tax Parcel
CR 1900008

N89°00'00"E 401.00'

Edge of Farm Field

Garage

House
N5812

Shed

Lot 1
Tax Parcel
CA459200001
2.743 Acres
119,489 Sq.Ft.

Shed

Shed

S89°00'00"W 401.00'

Tax Parcel
CR 1900008

Notes:

The location of paved or gravel surfaces shown on this plat are approximate due to existing snow cover on the property at the time of the field survey. There may be additional improvements or encroachments on the property which were not visible at the time of the field survey and are not shown on this plat.

Plat of Survey

of

Lot 1 of Certified Survey Map No. 4592,

recorded in Vol. 30 of Certified Survey Maps of Walworth County on Page 130 and located in the Southwest 1/4 of Section 19, Town 3 North, Range 15 East, Town of Richmond, Walworth County, Wisconsin.

Surveyed for: **Brian & Jill Gunnink**
12114 Bradford Townhall Road
Darien, Wisconsin. 53114

Tax Parcel
CR 1900008

Bearings reference to the Wisconsin State
Plane Coordinate System, South Zone.

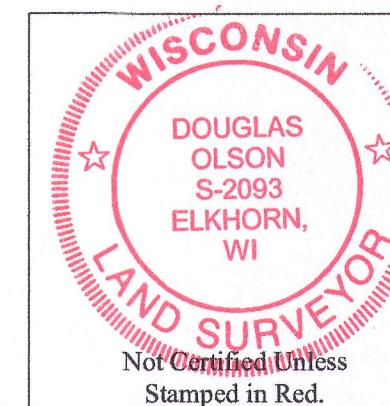
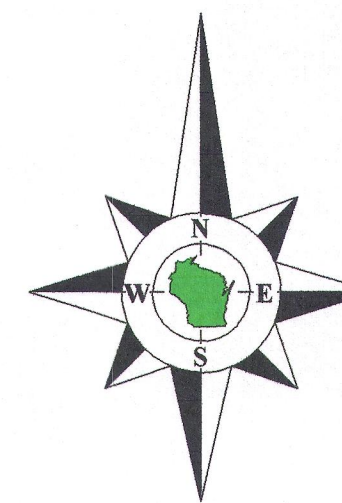

Notes:

- 1) This survey plat is not certified unless signed and sealed in red ink.
- 2) This survey is subject to Wisconsin lien laws. This Plat of Survey is the notice of intent to file lien. Lien waiver required.

Copyright 2015 by Olson Land Surveying, LLC.

All rights reserved. No part of this survey plat may be reproduced or transmitted in any form by any means - graphic, electronic, or mechanical, including photocopying, tracing, or information storage and retrieval systems - without permission in writing from Douglas G. Olson, Olson Land Surveying, LLC.

I, Douglas G. Olson, Wisconsin Professional Land Surveyor, do hereby certify that this survey was performed by me, or under my direction in full compliance with the owner's/agent's instructions and Chapter A-E 7 of the Wisconsin Administrative Code "Minimum Standards for Property Surveys", and that this map is an accurate representation thereof to the best of my knowledge and belief.

Douglas G. Olson
Wisconsin Professional Land Surveyor - 2093

Survey Date: March 10, 2015.
Revisions: No. 1 - Recorded CSM

Scale in Feet
1" = 30'
0' 15' 30' 60'

Olson Land Surveying, LLC



45 South Wisconsin Street * P.O. Box 322 * Elkhorn, Wisconsin. 53121
Telephone: (262) 723-3434 * Facsimile: (262) 723-8044
Email: doug@olsonsurveying.com

Legend
Found County Section Corner
Set Iron Pipe, 1" dia.
Recorded Information
Utility Pole
Fiber Optic Sign
Utility Pedestal
Concrete Cover
Septic Vent
Asphalt Surface
Gravel
Concrete Surface
Brick

Sheet 1 of 1 Sheets

Drawing Name:

Job Reference Number

2015.011

2015.011

CA4592-1

315-1232