

# Property Exhibit

of

Tax Parcel  
CR 1800002D

## Lot 1 of Certified Survey Map No. 1635,

recorded in Vol. 7 of Certified Survey Maps of Walworth County on Page 325 and located in the Southeast 1/4 of Section 18 and the Northeast 1/4 of Section 19, Town 3 North, Range 15 East, Town of Richmond, Walworth County, Wisconsin.

Prepared for:

### Sugar Creek Dairy, LLC

N5633 County Road O  
Elkhorn, Wisconsin. 53121

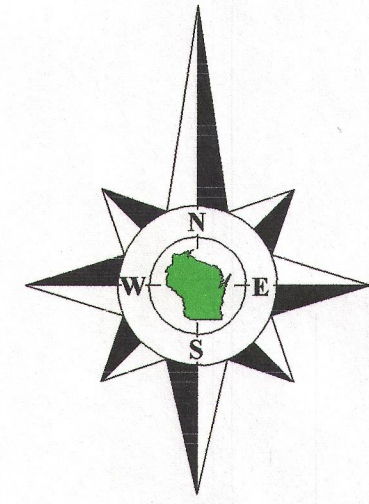

Bearings reference to Certified  
Survey Map No. 1635.

Survey Date: March 22, 2013.  
Revisions:

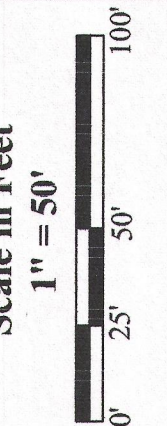

Tax Parcel  
CR 1800002

**Lot 1**  
**Tax Parcel**  
**CA163500001**

7.340 Acres  
319,722 Sq.Ft.  
6.806 Acres  
296,484 Sq.Ft.  
Exclusive of R.O.W.

Tax Parcel  
CR 1800009

South 1/4 Corner  
Section 18-3-15  
N. 261,603.43  
E. 2,330,956.07

Southeast Corner  
Section 18-3-15  
N. 261,658.98  
E. 2,333,595.82

(N1°00'04"W 504.02')  
**N0°59'04"W 504.40'**  
470.15'  
(469.78')

(403.78')  
403.78'  
**S0°59'23"E 438.04'**  
(S1°00'E 438.02')

N89°44'02"E 641.93'

(N88°47'40"E 2640.44') State Plane  
N89°44'02"E 2640.41'  
South line of the Southeast 1/4 Section 18-3-15.  
North line of the Northeast 1/4 Section 19-3-15.

(S73°30'00"W 704.29')  
S73°30'00"W 704.17'

(S73°30'00"W 704.29')  
S73°30'00"W 704.17'

**County Trunk Highway A** (66' Wide)



Copyright 2013 by Jensen & Olson Land Surveying, LLC.

All rights reserved. No part of this survey plat may be reproduced or transmitted in any form by any means - graphic, electronic, or mechanical, including photocopying, tracing, or information storage and retrieval systems - without permission in writing from Douglas G. Olson, Jensen & Olson Land Surveying, LLC.

I, Douglas G. Olson, Wisconsin Registered Land Surveyor, do hereby certify that this survey was performed by me, or under my direction in full compliance with the owner's/agent's instructions and Chapter A-E 7 of the Wisconsin Administrative Code "Minimum Standards for Property Surveys"; and that this map is an accurate representation thereof to the best of my knowledge and belief.

Douglas G. Olson  
Wisconsin Registered Land Surveyor - 2093

**Notes:**

- 1) This Property Exhibit is not an original unless signed and sealed in red ink.
- 2) This exhibit is subject to Wisconsin lien laws. This Property Exhibit is the notice of intent to file lien. Lien waiver required.

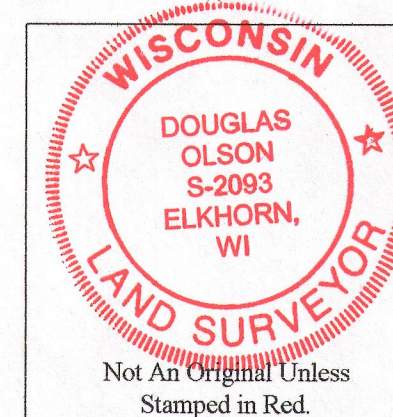

**Jensen & Olson Land Surveying, LLC**

45 South Wisconsin Street \* P.O. Box 322 \* Elkhorn, Wisconsin. 53121  
Telephone: (262) 723-3434 \* Facsimile: (262) 723-8044  
Email: jensen.olson@elknet.net

**Legend**

- Found County Section Corner
- Found Iron Pipe
- Found Iron Rod with Cap
- Set 604 Spike
- ( ) Recorded Information

Sheet 1 of 1 Sheets  
Drawing Name: chn15c-2013-01-190121Exhibit.dwg

Job Reference Number  
**2013.021**

**2013.021**

315-1201