

Surveyed for: **Bill Thiel**
N7177 Woodfield Lane
Whitewater, Wisconsin. 53190

Plat of Survey

of

A parcel of land described in a Warranty Deed recorded March 20, 2002 as Document No. 504247 as shown below:

Parcel 7 of Timber Trails, an unrecorded subdivision being described as follows: That part of the Northeast 1/4 of Section 2, Town 3 North, Range 15 East in the Town of Richmond, Walworth County, Wisconsin, bounded and described as follows: Commencing at the Southeast corner of said 1/4 Section; thence S 88° 29' 23" W, along the South line of said 1/4 Section 1317.84 feet to a point in the West line of the East 1/2 of said 1/4 Section; thence N 0° 30' 35" West, along said West line, 1527.65 feet to a point of beginning; continuing N 0° 30' 35" W, along said West line, 360.00 feet to a point; thence S 80° 27' 07" E, 724.90 feet to a point in the centerline of s proposed road; thence Southwesterly along said centerline (being a curved line having a radius of 1800.00 feet with its center to the Southeast and a chord 325.90 feet in length which bears S 13° 34' 27" W), an arc distance of 326.34 feet to a point; thence N 83° 05' 00" W, 639.82 feet to the point of beginning.

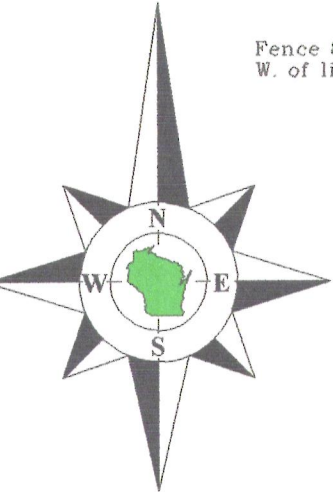

Bearings reference to previous surveys of record.

Lot 7
Lorwood Acres,
A Subdivision

East line of Lorwood Acres was established using the Concrete Monuments set by County Surveyor Lloyd L. Jensen in December 1941.
(S1°51'53"E 987.66') Lorwood Acres
S0°30'16"E 987.23' from Concrete Monument to Iron Rod

(N0°30'35"W 360.00')

Wire Fence

Fence 7.8' W. of line

Fence 8.1' W. of line

Pipe is 0.21' W. of the East line of Lorwood Acres.

Pipe is 0.18' W. of the East line of Lorwood Acres.

206.34' Between Pipe (206.35')

Shed
6.0' 13.1'

Garage
36.3' 32.3'

Deck
24.4' 20.1'
House
N7177
33.5' 24.2'

(S80°27'07"E 724.90')
S80°26'14"E 724.76'
691.34'

**Tax Parcel
C R 200015**
5.287 Acres
230,300 Sq.Ft.
5.039 Acres
219,511 Sq.Ft.
Exclusive of R.O.W.

**Tax Parcel
CR 200016**

N83°05'00"W 639.57'
(N83°05'00"W 639.82')

Radius=1800.00', Chord=S13°34'27"W 325.90'
Arc=327.66'

Radius=1800.00', Chord=S13°34'27"W 325.90'
Arc=326.18' (326.34')

Woodfield Lane
(66' Wide)

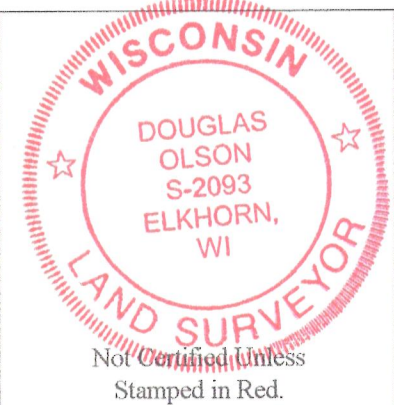

Not Certified Unless Stamped in Red.

Notes:

- This survey plat is not certified unless signed and sealed in red ink.
- This survey is subject to Wisconsin lien laws. This Plat of Survey is the notice of intent to file lien. Lien waiver required.

Middle 1/8 Corner of the Northeast 1/4 of Section 2-3-15.
Concrete Monument set by County Surveyor Lloyd L. Jensen in December 1941 is 1.85' S5°07'35"E of Iron Pipe set by William Yach in December 1977.

I hereby certify that I have surveyed the above described property and the map hereon is correct to the best of my professional knowledge and belief and shows the size and location of the property, its exterior boundaries, the location and dimensions of all visible structures thereon, boundary fences, apparent easements and roadways and visible encroachments, if any.
This survey is made for the exclusive use of the present owners of the property, and also those who purchase, mortgage or guarantee title thereto, within one year from the date hereof.

Douglas G. Olson
Wisconsin Registered Land Surveyor - 2093



Copyright 2012 by Jensen & Olson Land Surveying, LLC.

All rights reserved. No part of this survey plat may be reproduced or transmitted in any form by any means - graphic, electronic, or mechanical, including photocopying, tracing, or information storage and retrieval systems - without permission in writing from Douglas G. Olson, Jensen & Olson Land Surveying, LLC.

Survey Date: August 2, 2012.

Revisions:

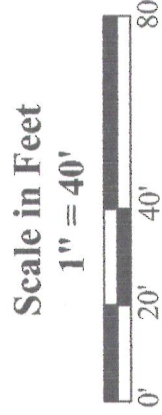

Jensen & Olson Land Surveying, LLC
45 South Wisconsin Street * P.O. Box 322 * Elkhorn, Wisconsin. 53121
Telephone: (262) 723-3434 * Facsimile: (262) 723-8044
Email: jensen.olson@elknet.net

- Legend**
- Found Concrete Monument
 - Found Iron Pipe
 - Found Iron Rod
 - Set Iron Pipe, 1" dia.
 - Recorded Information
 - Boundary or Federal
 - Concrete Cover
 - Septic Vent
 - Asphalt Surface
 - Concrete

Sheet 1 of 1 Sheets
Job Reference Number
2012.092

2012.092

CR 2-15

315-1181