

FARRIS, HANSEN & ASSOCIATES, INC.

ENGINEERING — ARCHITECTURE — SURVEYING
7 RIDGWAY COURT — P.O. BOX 437 — ELKHORN, WISCONSIN 53121
PHONE: (262) 723-2098 FAX: (262) 723-5886

PLAT OF SURVEY

LOT 1 CSM 3025, REC. AS DOC. 394530
LOCATED IN THE NW 1/4 OF THE SE 1/4 SEC. 15
T3N, R15E, TOWN OF RICHMOND, WALWORTH COUNTY, WI.

ASSIGNED NORTH LINE NW 1/4 OF SE 1/4
S 88°48'34" E

TURTLE LAKE ROAD

66' WIDE ROW

S 88°48'34" E
239.86

N 01°15'03" E
237.36

R=120.00
155.03
C=144.47
S 51°46'55" E

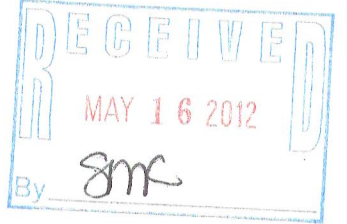

NOTE: COPIES OF THIS MAP TO WHICH THE FOLLOWING CERTIFICATE
WILL APPLY SHOW THE SURVEYOR'S ORIGINAL SEAL AND SIGNATURE
IN RED INK. COPIES BY ANY OTHER MEANS MAY HAVE ALTERATIONS
WHICH DO NOT REPRESENT THE SURVEYOR'S WORK PRODUCT.



I HEREBY CERTIFY THAT THE ABOVE DESCRIBED PROPERTY HAS BEEN
SURVEYED UNDER MY DIRECTION AND THAT THE ABOVE MAP IS A TRUE
REPRESENTATION THEREOF AND SHOWS THE SIZE AND LOCATION OF
THE PROPERTY AND ITS EXTERIOR BOUNDARIES. THIS SURVEY IS
MADE FOR THE USE OF THE PRESENT OWNERS OF THE PROPERTY, AND
ALSO THOSE WHO PURCHASE, MORTGAGE, OR GUARANTEE THE TITLE
THERETO WITHIN ONE YEAR FROM THE DATE HEREOF.

DATED: 9-26-1998

REVISED 2-21-2012
TO SHOW SIZE &
LOCATION OF PROPOSED
RESIDENCE

PETER S. GORDON R.L.S. 2101

LOT 1

229,415 S.F. EXCLUSIVE OF
ROAD ROW (5.27 ACRES)

LEGEND

- = FOUND IRON REBAR STAKE
- (XXX) = RECORDED AS

PROPOSED RESIDENCE & DECK

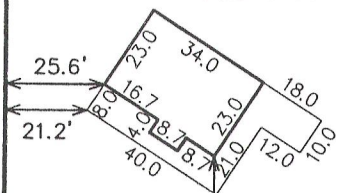

N 01°15'03" E
306.19

190.4'

395.70
N 88°45'58" W

540.20
S 01°12'27" W

— WORK ORDERED BY —
DIANE GILLESPIE
1521 IROQUOIS AVE
ST CHARLES, IL. 60174

PROJECT: 5770
DATE: 02-21-2012
SHEET 1 OF 1