

PLAT OF SURVEY

LOCATION: Partridge Woods Court, Lyons, Wisconsin

LEGAL DESCRIPTION: Lot 3 in PARTRIDGE WOODS, a subdivision located in the Northeast 1/4, the Southeast 1/4 and the Southwest 1/4 of Section 23, Town 2 North, Range 18 East, Town of Lyons, Walworth County, Wisconsin.

April 9, 1998

Survey No. 89357

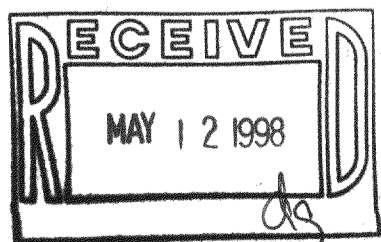

SCALE: 1"=60'

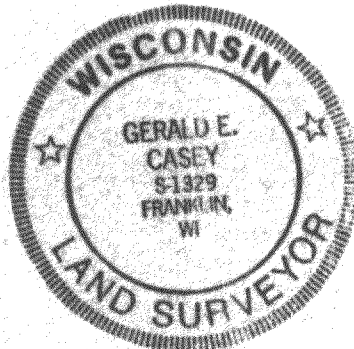

I HEREBY CERTIFY THAT I HAVE SURVEYED THE ABOVE DESCRIBED PROPERTY AND THAT THE ABOVE MAP IS A TRUE REPRESENTATION THEREOF AND SHOWS THE SIZE AND LOCATION OF THE PROPERTY, ITS EXTERIOR BOUNDARIES, THE LOCATION OF ALL VISIBLE STRUCTURES AND ENCLOSURES OF ALL PRINCIPAL BUILDINGS THEREON, BOUNDARY FENCES, APPARENT EASEMENTS AND ROADWAYS AND VISIBLE ENCROACHMENTS, IF ANY.

THIS SURVEY IS MADE FOR THE EXCLUSIVE USE OF THE PRESENT OWNERS OF THE PROPERTY, AND ALSO THOSE WHO PURCHASE, MORTGAGE, OR GUARANTEE THE TITLE THERETO WITHIN ONE (1) YEAR FROM DATE HEREOF.

NPRW-3  
218-991