

ABERNATHY and ASSOCIATES

Kenneth B. Abernathy Jr.

Wisconsin Registered Land Surveyor S-1594

Rt. 3, Box 273  
Elkhorn, Wisconsin 53121  
Phone: (414) 723-4260 (office)  
(414) 723-4813 (residence)

PLAT OF SURVEY

LOT 42 OF GENEVA TERRITORY FIRST  
ADDITION, LOCATED IN THE  
SOUTHEAST 1/4 OF SECTION 29, TOWN  
2 NORTH, RANGE 18 EAST, TOWN OF  
LYONS, WALWORTH COUNTY, WISCONSIN.

NORTH LINE OF SUBDIVISION  
N 89°31'40" E 130.00'

LOT 41

LOT 42

1.23 ACRES

LOT 43

ORDERED BY: SCHAUDE BUILDERS

OWNER: CURTIS AND PAMELA HEJDUK  
P.O. BOX 78  
FONTANA, WI. 53125

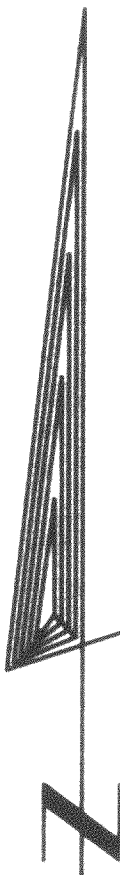

SCALE 1" = 40 FEET

PROPOSED RESIDENCE

10' WIDE UTILITY EASEMENT

CURVE	ARC	DELTA	RADIUS	CHORD LENGTH	CHORD BEARING
C1	92.04	23°38'55"	223.00	91.39	S 63°49'15" W
C2	45.21	39°14'44"	66.00	44.33	N 87°38'05" W

LINE	DISTANCE
L1	13.00
L2	6.00
L3	6.00

NOTE:  
THIS FIRM WAS HIRED TO LOCATE A PROPOSED RESIDENCE ON LOT 42.  
THE ORIGINAL MONUMENTATION WAS FOUND ALONG THE ROAD LINE WAS  
USED TO STAKE THE PROPOSED RESIDENCE. THE REAR CORNERS WERE NOT  
LOCATED BY AGREEMENT WITH THE CONTRACTOR DUE TO FOLIAGE AND  
SWAMP.

OUTLOT 1

DEERPATH ROAD  
66' WIDE PRIVATE ROAD

Legend

- FOUND IRON PIPE
- FOUND IRON ROD
- FOUND BRASS CAPPED MONUMENT
- ✱ FOUND CONCRETE MONUMENT
- ✱ CHISEL CUT IN CONCRETE
- SET IRON ROD, 24" LONG, WEIGHING 1.5 LBS., LINEAL FT. 3/4" DIA.
- SET IRON ROD, 10" LONG, WEIGHING 0.5 LBS., LINEAL FT. 1/4" DIA.
- (XX) RECORDED AS DIMENSION
- - - - - EXISTING FENCE

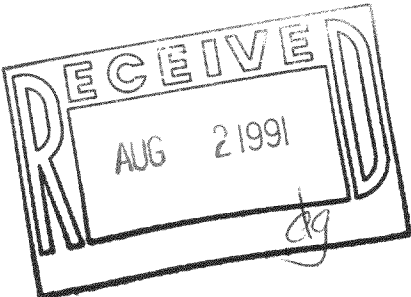

SCALE: 1" = 40 FEET

"I hereby certify that I have surveyed the above described  
property and that the above map is a true representation  
thereof and shows the size and location of the property, its  
exterior boundaries, the location of all visible structures  
and dimensions of all principal buildings thereon, boundary  
fences, apparent easements, roadways and visible encroach-  
ments, if any."  
"This survey is made for the use of the present owners of  
the property, and also those who purchase, mortgage, or  
guarantee the title thereto within one year from date  
hereof."

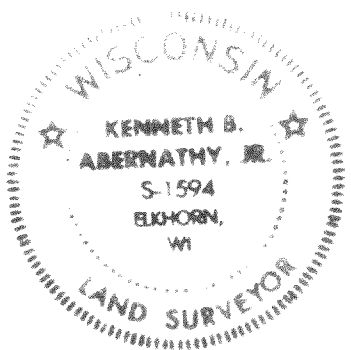

*Kenneth B. Abernathy Jr.*  
KENNETH B. ABERNATHY, JR.  
WISCONSIN REGISTERED LAND SURVEYOR,  
S-1594

Date: 6/10/91 Job No. 91605