

LOT 3 OF CERTIFIED SURVEY MAP NO. 4782 AS
RECORDED IN VOLUME 32 OF CERTIFIED SURVEY
MAPS, PAGE 8 AS DOCUMENT NO. 968332 IN THE
OFFICE OF THE REGISTER OF DEEDS IN AND FOR
WALWORTH COUNTY, WISCONSIN, BEING PART OF THE
NORTHWEST 1/4 OF THE NORTHWEST 1/4 OF
SECTION 14, TOWNSHIP 2 NORTH, RANGE 18 EAST OF
THE 4TH PRINCIPAL MERIDIAN IN THE TOWN OF
LYONS, WALWORTH COUNTY, WISCONSIN.

BEARINGS HEREON RELATE TO THE NORTH LINE OF
LOT 3, CERTIFIED SURVEY MAP NO. 4782. ASSUMED
BEARING SOUTH 89°22'03" EAST.

"I hereby certify that I have surveyed the above described property and that the above map is a correct representation thereof and shows the size and location of the property, its exterior boundaries, the location of all visible structures and dimensions of all principal buildings thereon, boundary fences, apparent easements, roadways and encroachments, if any."

"This survey is made for the use of the present owners of the property, and those who purchase, mortgage, or guarantee the title thereto within one year from date hereof."

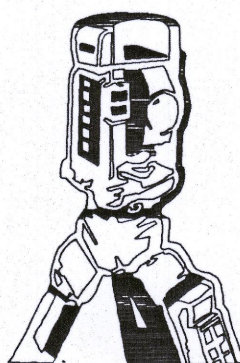

412 N. PINE STREET
BURLINGTON, WI 53105
(262)-767-0225

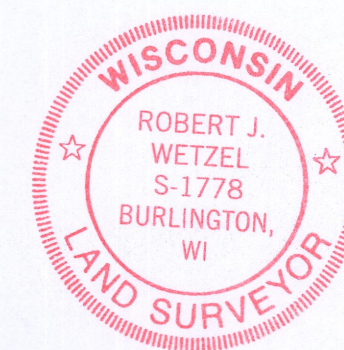
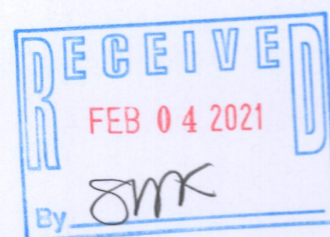

THIS IS NOT AN ORIGINAL PRINT
UNLESS THIS SEAL IS RED.

Robert J. Wetzel
ROBERT J. WETZEL S-1778

<i>DRAWN BY:</i> rw/bw	<i>DATE:</i> DECEMBER 7, 2020
<i>CHECKED BY:</i> rw/dw	<i>DRAWING NO.:</i> 10283-ELEV
<i>JOB NO.:</i> 10283-ELEV	<i>SHEET</i> 1 <i>OF</i> 1

NA4782-3

218-2099