

LOT 1 OF CERTIFIED SURVEY MAP NO. 4730, ACCORDING TO THE RECORDED PLAT THEREOF RECORDED ON SEPTEMBER 25, 2017 IN VOLUME 31 OF CERTIFIED SURVEYS ON PAGE 174 AS DOCUMENT NO. 954297, BEING A REPLAT OF LOT 2 OF CERTIFIED SURVEY MAP NO. 2792, RECORDED IN VOLUME 14 OF CERTIFIED SURVEY MAPS ON PAGES 206 AND 207 IN THE OFFICE OF THE REGISTER OF DEEDS IN AND FOR WALWORTH COUNTY, WISCONSIN AND PART OF LANDS LOCATED IN PART OF THE SOUTHEAST 1/4 OF THE NORTHEAST 1/4 OF SECTION 17, TOWNSHIP 2 NORTH, RANGE 18 EAST OF THE FOURTH PRINCIPAL MERIDIAN IN THE TOWNSHIP OF LYONS, WALWORTH COUNTY, WISCONSIN.

BEARINGS HEREON RELATE TO THE SOUTH LINE OF THE NORTHEAST 1/4 OF SECTION 7-2-18, ASSUMED BEARING SOUTH 89°46'15" WEST.

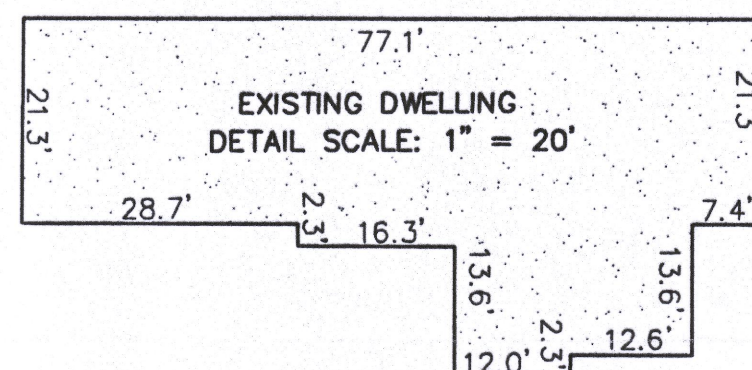

- ✂ FOUND 3/4" IRON ROD
- FOUND 1-5/16" (D. IRON PIPE
- ⊕ FOUND WALWORTH COUNTY MONUMENT (CONCRETE/CAP)

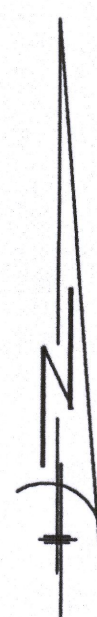
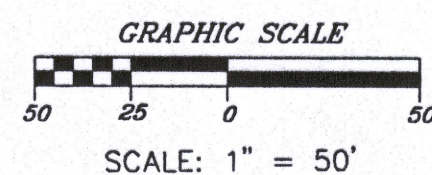

"I hereby certify that I have surveyed the above described property and that the above map is a correct representation thereof and shows the size and location of the property, its exterior boundaries, the location of all visible structures and dimensions of all principal buildings thereon, boundary fences, apparent easements, roadways and encroachments, if any."

"This survey is made for the use of the present owners of the property, and those who purchase, mortgage, or guarantee the title thereto within one year from date hereof."

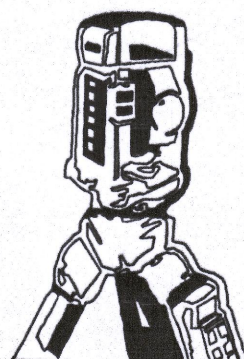

412 N. PINE STREET
BURLINGTON, WI 53105
(262)-767-0225

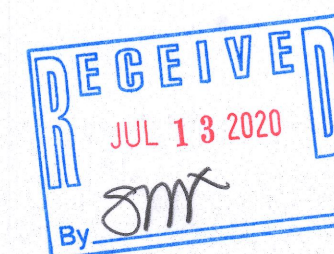
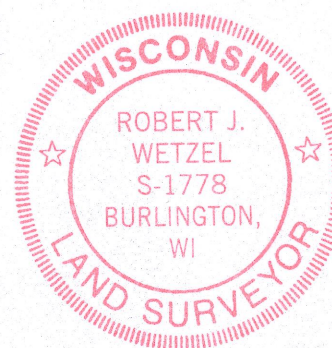

THIS IS NOT AN ORIGINAL PRINT
UNLESS THIS SEAL IS RED.

Robert J. Wetzel
ROBERT J. WETZEL S-1778

DRAWN BY: <i>RW/ MT</i>	DATE: <i>2-6-2020</i>
CHECKED BY: <i>BW/DW</i>	DRAWING NO.: <i>9385 D2</i>
JOB NO.: <i>9385</i>	SHEET <i>1</i> OF <i>1</i>

NA4730-1