

# Plat of Survey

of

## Lots 62 and 63 of Lake Geneva Golf Hills,

a subdivision located in the Southeast 1/4 of the Northwest 1/4 of Section 31,  
Town 2 North, Range 18 East, Town of Lyons, Walworth County, Wisconsin.

Surveyed for: **Phil Morgenthaler**  
500 West Palatine Road  
Arlington Heights, Illinois. 60004

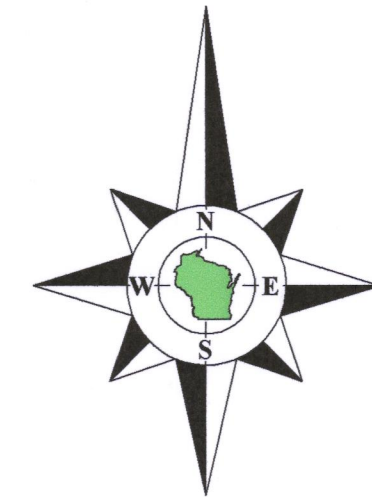

Bearings reference to previous  
surveys of record.

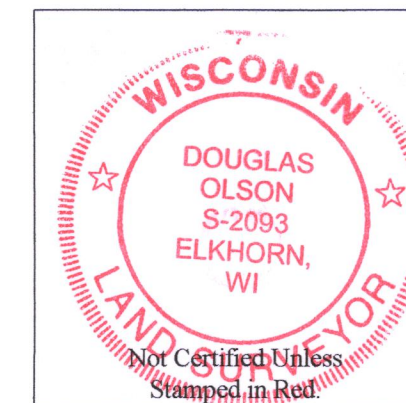

### Notes:

- 1) This Plat of Survey is not certified unless signed and sealed in red ink.
- 2) This survey is subject to Wisconsin lien laws. This Plat of Survey is the notice of intent to file lien. Lien waiver required.
- 3) The Survey Date shown on this Plat of Survey is the completion date of the field work.

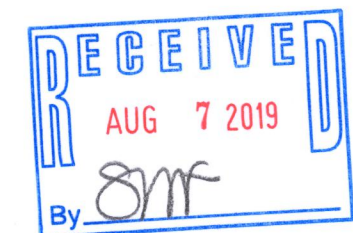

Copyright ©2019 by Olson Land Surveying, LLC.

All rights reserved. No part of this survey plat may be reproduced or transmitted in any form by any means - graphic, electronic, or mechanical, including photocopying, tracing, or information storage and retrieval systems - without permission in writing from Douglas G. Olson, Olson Land Surveying, LLC.

I hereby certify that I have surveyed the above described property in compliance with Chapter A-E 7 of the Wisconsin Administrative Code and that the map hereon is correct to the best of my professional knowledge and belief and shows the size and location of the property, its exterior boundaries, the location and dimensions of all visible structures thereon, boundary fences, apparent easements and roadways and visible encroachments, if any.

This survey is made for the exclusive use of the present owners of the property, and also those who purchase, mortgage or guarantee title thereto, within one year from the date hereof.

Douglas G. Olson  
Wisconsin Professional Land Surveyor - 2093

Survey Date: June 10, 2019.  
Revisions:

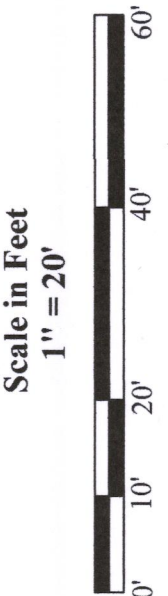

45 South Wisconsin Street | P.O. Box 322  
Elkhorn, Wisconsin 53121  
Telephone: (262) 723-3434  
Facsimile: (262) 723-8044  
Email: doug@olsonsurveying.com  
Website: www.olsonsurveying.com

**OLSON**  
LAND SURVEYING, LLC  
Rural | Residential | Commercial

**Legend of Symbols & Abbreviations**  
N North  
S South  
E East  
W West  
In Bearings  
Degrees  
Minutes  
Seconds  
In Distances  
Inches  
Found Iron Pipe  
Found Iron Rod  
Found Iron Rod July 29, 2008.  
Found Iron Rod June 10, 2019.  
Found Spindle  
Recorded Information  
Easement  
Boundary  
Utility Pedestal  
Fire Hydrant  
Water Valve  
Asphalt Surface  
Gravel Surface

Sheet 1 of 1 Sheets  
Drawing Name:  
Job Reference Number  
**2019.055**

2019.055

Lawton Avenue

East Drive

Outlot 1  
C.S.M. 1787  
"Reserved for  
right-of-way"

Tax Parcel  
NGH 00050

0.247 Acre  
10,774 Sq.Ft.

House  
No. 7242

Lot 63

Lot 62

Lot 61

Lot 65

Lot 66

Lot 139

Lot 140

Lot 141

Lot 142

Lot 143

NGH-50

218-2055