

**SATTER SURVEYING, LLC**  
LAND SURVEYS, MAPPING AND PLANNING  
272 ORIGIN STREET  
BURLINGTON, WI 53105  
262-661-4239

"I HEREBY CERTIFY THAT I HAVE SURVEYED THE ABOVE DESCRIBED PROPERTY AND THAT THE ABOVE MAP IS A CORRECT REPRESENTATION THEREOF AND SHOWS THE SIZE AND LOCATION OF THE PROPERTY, ITS EXTERIOR BOUNDARIES, THE LOCATION OF ALL VISIBLE STRUCTURES AND DIMENSIONS OF ALL PRINCIPAL BUILDINGS THEREON, BOUNDARY FENCES, APPARENT EASEMENTS, ROADWAYS AND ENCROACHMENTS, IF ANY."

"THIS SURVEY IS MADE FOR THE USE OF THE PRESENT OWNERS OF THE PROPERTY, AND THOSE WHO PURCHASE, MORTGAGE, OR GUARANTEE THE TITLE THERETO WITHIN ONE YEAR FROM DATE HEREOF."

BEARINGS HEREON RELATE TO GRID NORTH OF THE WISCONSIN STATE PLANE COORDINATE SYSTEM, SOUTH ZONE. ASSUMED BEARING OF NORTH 88°31'24" EAST ON THE NORTH LINE OF THE SOUTHEAST 1/4 OF SECTION 25-2-18 PER CERTIFIED SURVEY MAP NO. 3857.

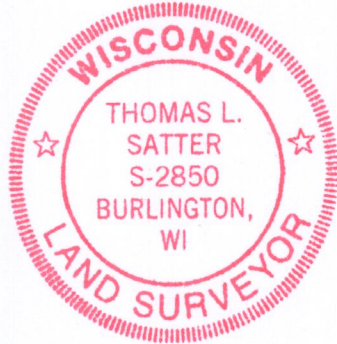
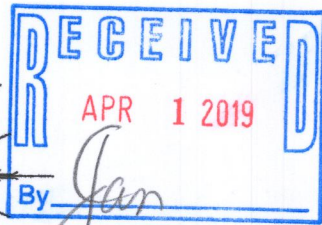
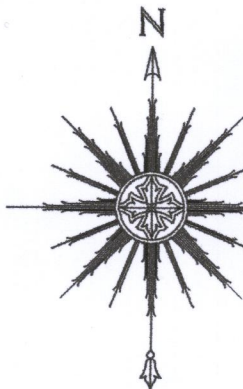

THIS IS NOT AN ORIGINAL PRINT  
UNLESS THIS SEAL IS RED.

*Thomas L. Satter*  
THOMAS L. SATTER S-2850

MARCH 11, 2019  
DATE

031901  
JOB NUMBER

NA3857-1

218-2038