

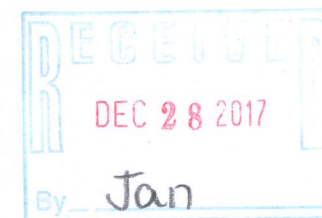

LEGEND

- FOUND IRON PIPE
- FOUND P.K. NAIL
- ⊙ FOUND 2' IRON PIPE
- () RECORDED AS

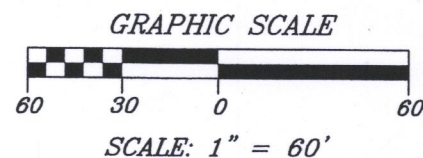

PROPOSED BUILDING WAS STAKED ON ACTUAL CORNERS WITH 5 FOOT CONTROL ON THE WEST LINE. IT IS THE CONTRACTORS RESPONSIBILITY TO FIELD VERIFY ALL STAKES FOR LOCATION AND DIMENSION PRIOR TO CONSTRUCTION. IF ANY DISCREPANCIES OCCUR, NOTIFY THIS OFFICE AT ONCE.

NOTE: BEARINGS HEREON RELATE TO THE NORTH LINE OF RUEDEBUSCH ROAD, ASSUMED BEARING SOUTH 88°57'28" WEST.

"I hereby certify that I have surveyed the above described property and that the above map is a correct representation thereof and shows the size and location of the property, its exterior boundaries, the location of all visible structures and dimensions of all principal buildings thereon, boundary fences, apparent easements, roadways and encroachments, if any."

"This survey is made for the use of the present owners of the property, and those who purchase, mortgage, or guarantee the title thereto within one year from date hereof."

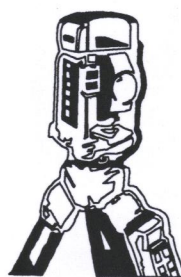

B.W. SURVEYING, INC.

LAND SURVEYS
MAPPING AND PLANNING
412 N. PINE STREET
BURLINGTON, WI 53105
(262)-767-0225

RUEDEBUSCH
PRIVATE ROAD KNOWN AS OUTLOT 1
IN RUEDEBUSCH PINE SUBDIVISION

ROAD
N60°20'41"W
(N60°22'52"W)

PLAT OF SURVEY -OF-

LOT 2 OF CERTIFIED SURVEY MAP NO. 2399, RECORDED IN VOLUME 12 OF CERTIFIED SURVEYS ON PAGE 22 AS DOCUMENT NO. 276714, BEING PART OF THE NORTHEAST 1/4 OF SECTION 12, TOWN 2 NORTH, RANGE 18 EAST. SAID LAND BEING IN THE TOWN OF LYONS, COUNTY OF WALWORTH AND STATE OF WISCONSIN.

SURVEY FOR: ALLEN ERICKSON
SURVEY LOCATION: 5126 RUEDEBUSCH ROAD

THIS IS NOT AN ORIGINAL PRINT
UNLESS THIS SEAL IS RED.

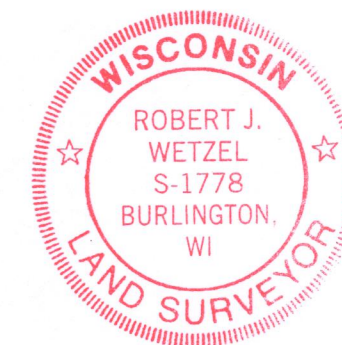

Robert J. Wetzel
ROBERT J. WETZEL S-1778

MAY 18, 2017
DATE

9349
JOB NUMBER

NA2399-2

218-1998