

of

Parcel 15:

Tax key # NVS 00085; Vacant land, Side Road, Elkhorn, WI 53121

Surveyed for:

102 North Wisconsin Street
Elkhorn, Wisconsin. 53121

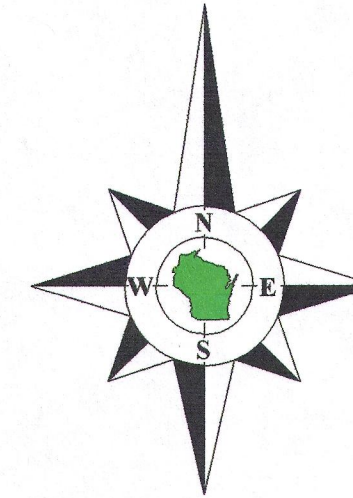

Bearings reference to the Wisconsin State Plane Coordinate System, South Zone.

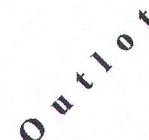

Notes:

- 1) This survey plat is not certified unless signed and sealed in red ink.
- 2) This survey is subject to Wisconsin lien laws. This Plat of Survey is the notice of intent to file lien. Lien waiver required.

Copyright 2014 by Jensen & Olson Land Surveying, LLC.

All rights reserved. No part of this survey plat may be reproduced or transmitted in any form by any means - graphic, electronic, or mechanical, including photocopying, tracing, or information storage and retrieval systems - without permission in writing from Douglas G. Olson, Jensen & Olson Land Surveying, LLC.

Tax Parcel
NVS 00084

I hereby certify that I have surveyed the above described property and the map hereon is correct to the best of my professional knowledge and belief and shows the size and location of the property, its exterior boundaries, the location and dimensions of all visible structures thereon, boundary fences, apparent easements and roadways and visible encroachments, if any.

This survey is made for the exclusive use of the present owners of the property, and also those who purchase, mortgage or guarantee title thereto, within one year from the date hereof.

Douglas G. Olson
Wisconsin Professional Land Surveyor - 2093

Revisions:

Survey Date: December 29, 2014.

Scale in Feet
1" = 20'

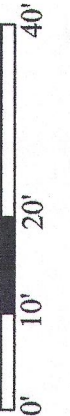

Jensen & Olson Land Surveying, LLC

Wisconsin Street I.O. Box 324 Elkton, Wisconsin 53121
Telephone: (262) 723-3434 * **Facsimile:** (262) 723-8044
Email: jensen.olson@elknet.net

Legend

☐ Round Iron Pipe
☐ Set Iron Pipe, 1" dia.
☐ Recorded Information
☒ Utility Pole
☒ Utility Pedestal
☒ Asphalt Surface

Sheet 1 of 1 Sheets

Job Reference Number
2014.134

2014.134

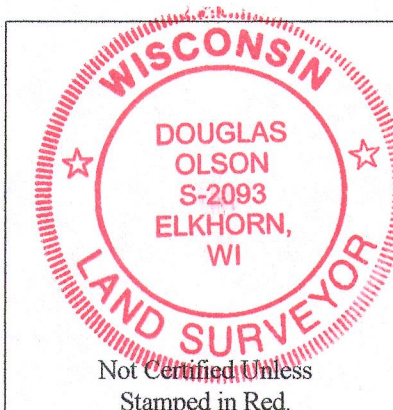

NV8-85

218-1893