

West 1/4 Corner
Section 7-2-18
N 240.001.72
E 2,424,265.77

Tax Parcel
NLY 700006

N88°56'26"E 216.85'

Plat of Survey

of

Lot 1 of Certified Survey Map No. 4591,

recorded in Vol. 30 of Certified Survey Maps of Walworth County on
Page 127 and located in the Southwest 1/4 of Section 7, Town 2 North,
Range 18 East, Town of Lyons, Walworth County, Wisconsin.

Surveyed for:

Coldwell Banker, Leith & Associates

102 North Wisconsin Street
Elkhorn, Wisconsin. 53121

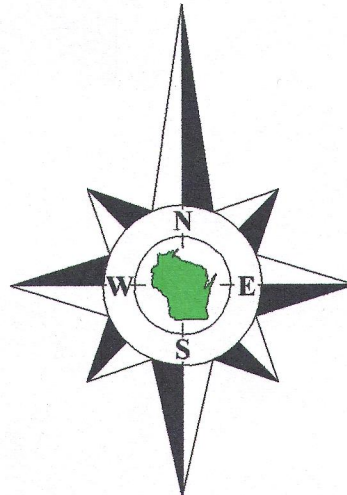

Bearings reference to the Wisconsin State
Plane Coordinate System, South Zone.

Tax Parcel
NLY 700006

Weeks Road
(66' Wide)

West line of the Southwest 1/4 of Section 7-2-18.
N1°03'34"W 2643.05'
(N1°03'34"W 2642.96')

Overhead Wires

100.5'

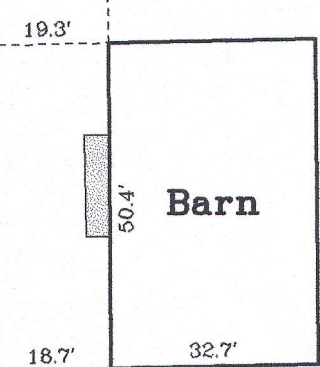

Well

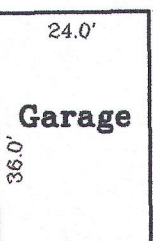

100.5'

S1°03'34"E 383.67'

Lot 1
Tax Parcel
NA459100001

2.046 Acres
89,139 Sq.Ft.

Well

N1°03'34"W 438.46'

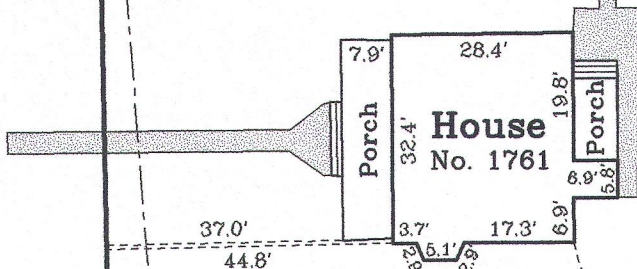

Guy

Overhead Wires

S74°45'36"W 223.66'

Tax Parcel
NLY 700010

White River State Trail

Former Racine & Mississippi Railroad
Former Chicago, Milwaukee, St. Paul & Pacific Railroad

Copyright 2014 by Jensen & Olson Land Surveying, LLC.

All rights reserved. No part of this survey plat may be reproduced or transmitted in
any form by any means - graphic, electronic, or mechanical, including photocopying,
tracing, or information storage and retrieval systems - without permission in writing
from Douglas G. Olson, Jensen & Olson Land Surveying, LLC.

I hereby certify that I have surveyed the above described property and the map
hereon is correct to the best of my professional knowledge and belief and shows the size
and location of the property, its exterior boundaries, the location and dimensions of all
visible structures thereon, boundary fences, apparent easements and roadways and
visible encroachments, if any.

This survey is made for the exclusive use of the present owners of the property,
and also those who purchase, mortgage or guarantee title thereto, within one year from
the date hereof.

Douglas G. Olson
Wisconsin Professional Land Surveyor - 2093

Notes:

- 1) This survey plat is not
certified unless signed
and sealed in red ink.
- 2) This survey is subject to Wisconsin lien laws.
This Plat of Survey is the notice of intent
to file lien. Lien waiver required.

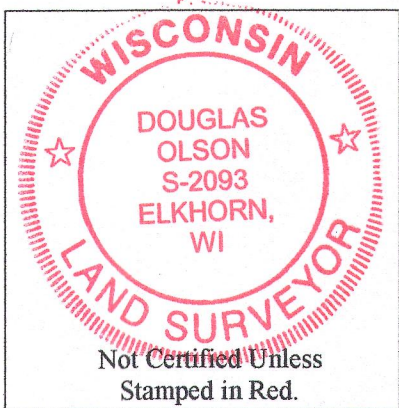
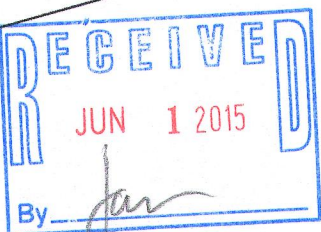

Southwest Corner
Section 7-2-18
N 237.359.28
E 2,424,314.63

Legend

- Found County Section Corner
- Found Iron Pipe
- Set Iron Pipe, 1" dia.
- Recorded Information
- Utility Pole
- Septic Vent
- Concrete Cover
- Asphalt Surface
- Concrete Surface
- Gravel



Jensen & Olson Land Surveying, LLC

45 South Wisconsin Street * P.O. Box 322 * Elkhorn, Wisconsin. 53121

Telephone: (262) 723-3434 * Facsimile: (262) 723-8044

Email: jensen.olson@elknet.net

Scale in Feet

1" = 30'



Survey Date: February 28, 2015.

Revisions: No. 1 - Recorded CSM

2014.134

Sheet 1 of 1 Sheets

Drawing Name:

Job Reference Number

2014.134

NA4591-1

218-1891