

PREPARED FOR
DIANE PIERRARD
SHOREWEST REALTY
LAKE GENEVA WI

PLAT OF SURVEY

- OF -

LOT 1 OF WALWORTH COUNTY CERTIFIED SURVEY MAP No. 335, RECORDED IN VOLUME 2 OF CERTIFIED SURVEYS ON PAGE 112 AT THE WALWORTH COUNTY REGISTER OF DEEDS, SAID LAND LYING AND BEING IN THE NE 1/4 OF THE NE 1/4 OF SECTION 21, TOWN 2 NORTH, RANGE 18 EAST OF THE FOURTH PRINCIPAL MERIDIAN, TOWN OF LYONS, WALWORTH COUNTY, WISCONSIN.

PATHFINDER SURVEYING INC.
(formerly)
J.K. SURVEYING INC.
P.O. BOX 322
LAKE GENEVA, WI. 53147
WWW.PATHFINDERSURVEYING.NET
262-248-8303

UNPLATTED LANDS

N 89°04'50" E
580.38' (580.08')

WIRE FENCE IS
0.5' +/- NORTH

WIRE FENCE IS
0.25' +/- NORTH

JONES ROAD

INSPECTION CAP

CONCTETE LID

WELL

asphalt

garage

Lot 1
3.10 acres
135080.00 sq ft

transformer

asphalt driveway

utilit pedestal

N 78°40'04" W 167.89'
(N 78°42'00" W 168.04')

Δ=65°36'19" R=154.95'
L=177.42'

S 68°28'16" W 127.32'
(S 68°24'45" W 127.34')

UNPLATTED LANDS
(S 00°53'35" E 286.86')
S 00°49'22" E 286.71'

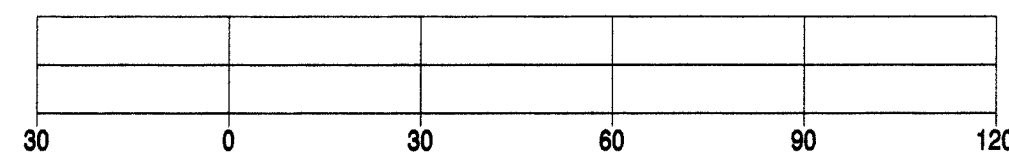
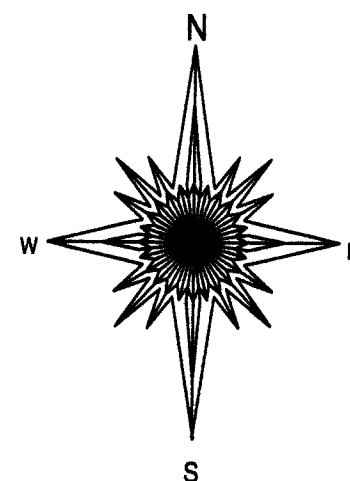

BASIS OF BEARING OF THIS PLAT: THE NORTH LINE OF CSM 335 WAS ASSUMED TO BEAR N89°04'50" E AS RECORDED ON SAID CSM.

- () = recorded as
- = found iron bar
- = found iron pipe
- = set iron pipe
- = set iron bar

SCALE 1" = 30'

JOB # 14-46

TAX ID #
NA33500001

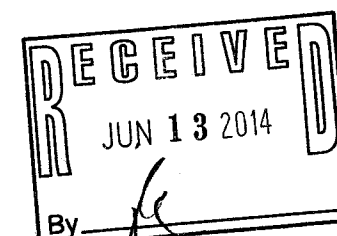
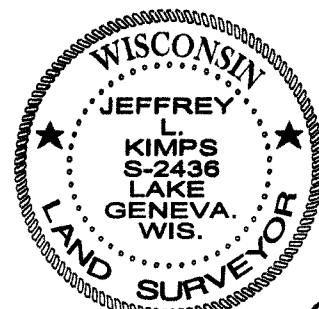

JEFFREY L. KIMPS S - 2436
Wisconsin Registered Land Surveyor
(original if signed in red)

"I hereby certify that I have surveyed the above described property and that the above map is a true representation of its exterior boundaries and shows the size and location of all visible structures, apparent easements and encroachments if any." This survey is made for the present owners of the property, and those who purchase, mortgage, or guarantee the title thereto, within one year from the date hereof.

DATED THIS 1ST DAY OF APRIL, 2014.

NA 335-1

218-1859