

PREPARED FOR
MIKE PFAMMATTER
KEEFE RAL ESTATE
LAKE GENEVA, WI

PATHFINDER SURVEYING INC.
(formerly)
J.K. SURVEYING INC.
P.O. BOX 322
LAKE GENEVA, WI 53147
WWW.PATHFINDERSURVEYING.NET
262-248-8303

PLAT OF SURVEY

OF

LOT 18 AND OUTLOT 3, CRANBERRY KNOLLS, ACCORDING TO THE RECORD PLAT THEREOF. SAID LAND BEING IN THE TOWN OF LYONS, COUNTY OF WALWORTH AND STATE OF WISCONSIN. ALSO IN THE TOWN OF WHEATLAND, COUNTY OF KENOSHA, STATE OF WISCONSIN.

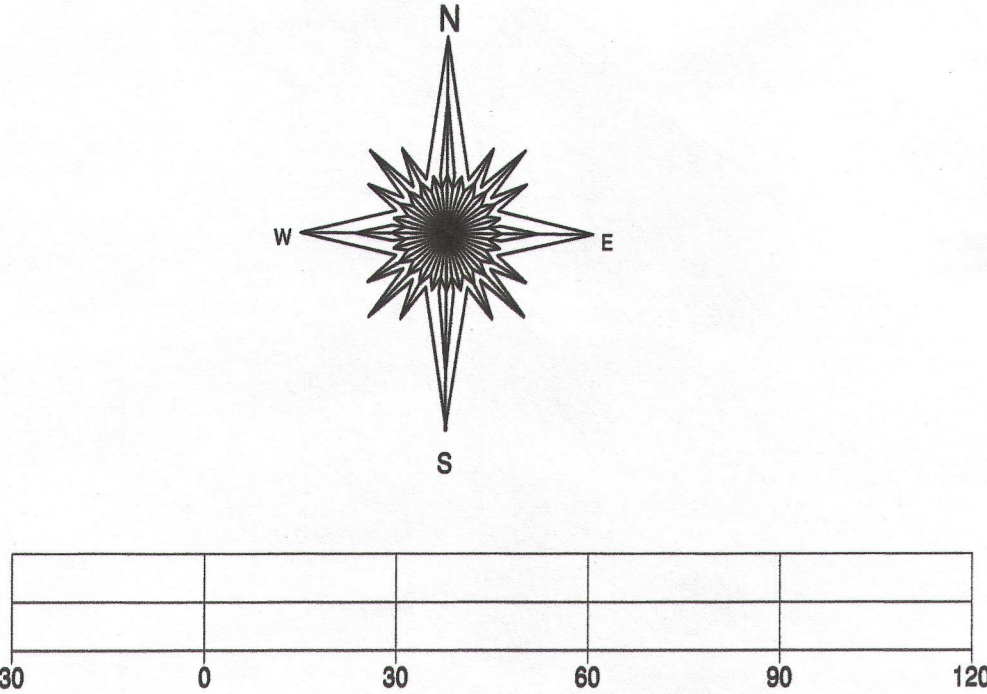

- () = recorded as
- = found iron bar
- = found iron pipe
- = set iron pipe
- = set iron bar

SCALE " = 30'

JOB # 13-187

TAX KEY # 95-4-219-312-0278
NCK 00031

"I hereby certify that I have surveyed the above described property and that the above map is a true representation of its exterior boundary and shows the size and location of all visible structures, apparent easements and encroachments if any."

This survey is made for the present owners of the property, and those who purchase, mortgage, or guarantee the title thereto, within one year from the date hereof.

DATED THIS 1ST DAY OF OCTOBER, 2013.

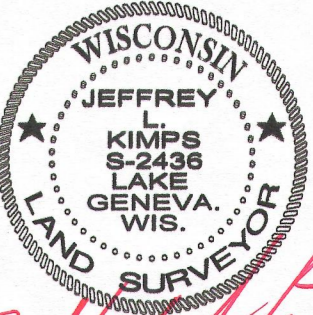

JEFFREY L. KIMPS S-2436
Wisconsin Registered Land Surveyor
(original if signed in red)

218-1845