

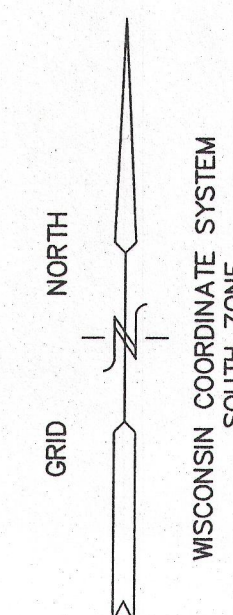

PLAT OF SURVEY

LOT 22 OF CRANBERRY KNOLLS A SUBDIVISION

LOCATED IN THE NE 1/4 OF THE SE 1/4 OF
THE NE 1/4 OF SECTION 36
TOWN 2 NORTH, RANGE 18 EAST
TOWN OF LYONS
WALWORTH COUNTY, WISCONSIN



LOT 21

LOT 21

LEGEND

- = FOUND IRON REBAR STAKE
- (xxx) = RECORDED AS

2013 WORK ORDERED BY:
PAUL BARTELSON
PO BOX 35
BURLINGTON, WI. 53105

NOTE: COPIES OF THIS MAP TO WHICH THE FOLLOWING
CERTIFICATE WILL APPLY SHOW SURVEYOR'S ORIGINAL SEAL AND
SIGNATURE IN RED INK. COPIES BY ANY OTHER MEANS MAY HAVE
ALTERATIONS WHICH DO NOT REPRESENT THE SURVEYOR'S WORK
PRODUCT.

I HEREBY CERTIFY THAT THE ABOVE DESCRIBED PROPERTY HAS
BEEN SURVEYED UNDER MY DIRECTION AND THAT THE ABOVE MAP
IS A TRUE REPRESENTATION THEREOF AND SHOWS THE SIZE AND
LOCATION OF THE PROPERTY AND ITS EXTERIOR BOUNDARIES.
THIS SURVEY IS MADE FOR THE USE OF THE PRESENT OWNERS OF
THE PROPERTY, AND ALSO THOSE WHO PURCHASE, MORTGAGE, OR
GUARANTEE THE TITLE THERETO WITHIN ONE YEAR FROM THE DATE
HEREOF.

DATED: JUNE 15, 2001

Peter S. Gordon
PETER S. GORDON R.L.S. 2101

REVISED 08-07-2013
TO SHOW SIZE & LOCATION OF AS BUILT FOUNDATION &
PROPOSED GARAGE

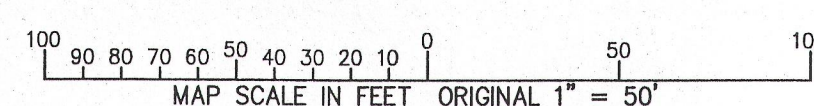
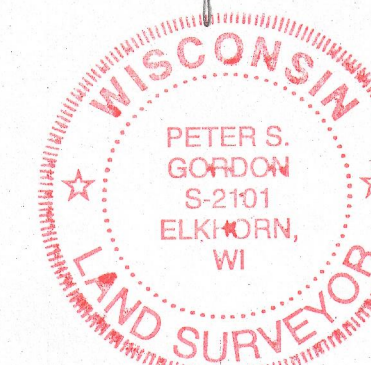
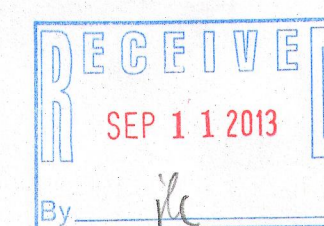

WORK ORDERED BY:
MARVIN & CAROL NEUMANN
6989 SOUTH STEELE ST
LITTLETON, CO. 80122

FARRIS, HANSEN & ASSOCIATES, INC.
ENGINEERING - ARCHITECTURE - SURVEYING
7 RIDGWAY COURT P.O. BOX 437
ELKHORN, WISCONSIN 53121
OFFICE: (262) 723-2098 FAX: (262) 723-5886

REVISIONS

PROJECT NO.
4171.22
DATE:
08-14-01
SHEET NO.
1 OF 1

NEK-22

218-1841

AUG 07 2013