

LAND-MARK SURVEYING
Mark L. Miritz
Wisconsin Registered Land Surveyor S-2582

N9330 Knuteson Drive
Whitewater, WI 53190
Phone: (262) 495-3284
FAX : (262) 495-8421
LAND-MARKSURVEYING.COM

PLAT OF SURVEY

UNIT 15, BRIDLEWOOD ESTATES, A CONDOMINIUM
LOCATED IN THE NORTHWEST 1/4 AND THE SOUTH-
WEST 1/4 OF SECTION 28 AND THE NORTHEAST 1/4
AND THE SOUTHEAST 1/4 OF SECTION 29, TOWN 2
NORTH, RANGE 18 EAST, LYONS TOWNSHIP,
WALWORTH COUNTY, WISCONSIN.

OWNER: M2 DEVELOPMENT CORP.
710 GENEVA STREET
LAKE GENEVA, WI 53147

UNIT 14

(N 81°30'04" E 271.47')
N 81°38'45" E 280.75'±

UNIT 15

100,992 TOTAL SQ. FT.

90,257 SQ. FT. ZONED C-3

POND
COMMON ELEMENT

POND LOCATION APPROXIMATE
DUE TO SNOW COVER

10,735 SQ. FT. ZONED C-1
(CONSERVANCY AREA)

WILDERNESS COURT
COMMON ELEMENT

66' WIDE PRIVATE ROAD - COMMON ELEMENT

10' WIDE UTILITY EASEMENT

DRIVE

UNIT 16

MOELTER
66' WIDE PRIVATE ROAD - COMMON ELEMENT

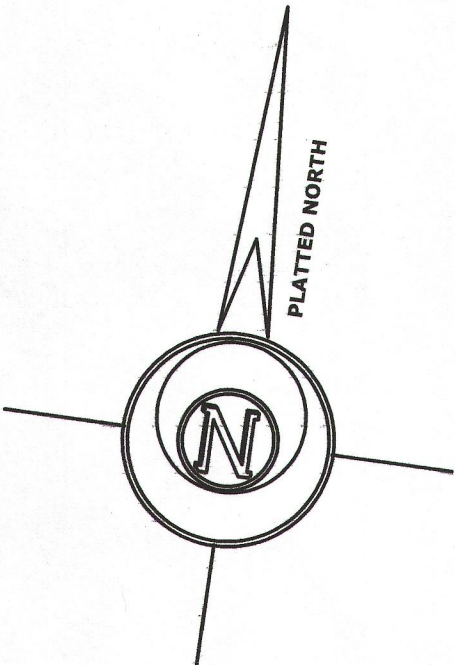

LEGEND

- FOUND IRON PIPE 1 1/4"
- FOUND IRON ROD 3/4"
- FOUND IRON PIPE 2"
- (x x) RECORDED AS DIMENSION

SCALE: 1 INCH = 50 FEET

"I hereby certify that the above described property has
been surveyed by me or under my direction and that the
above map is a true representation thereof and shows the
size and location of the property, its exterior boundaries,
the location of all visible structures and dimensions of all
principal buildings thereon, boundary fences, apparent
easements, roadways and visible encroachments, if any."
"This survey is made for the use of the present owners of
the property, and also those who purchase, mortgage, or
guarantee the title thereto within one year from date
hereof."

Mark L. Miritz
MARK L. MIRITZ
WISCONSIN REGISTERED
LAND SURVEYOR S-2582

DATE: FEB. 22, 2013 JOB NO. 13.201

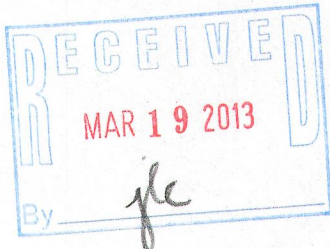

NBRE 00015

218-1815