

- OF -

PARCEL 2: LOT 40, LAKE ENEVA GOLF HILLS, A SUBDIVISION OF PART OF THE NORTHWEST 1/4, OF SECTION 31, TOWNSHIP 2 NORTH, RANGE 18 EAST, TOWN OF LYONS, WALWORTH COUNTY, WISCONSIN, EXCEPT, COMMENCE AT THE NORTHWEST CORNER OF LOT 40, THENCE SOUTH 29 FEET 6 INCHES, THENCE SOUTHEASTERLY 86 FEET 11 INCHES TO A POINT IN THE NORTHERLY LINE OF SAID LOT 40, THENCE NORTHWESTERLY 101 FEET 2 INCHES TO THE PLACE OF BEGINNING

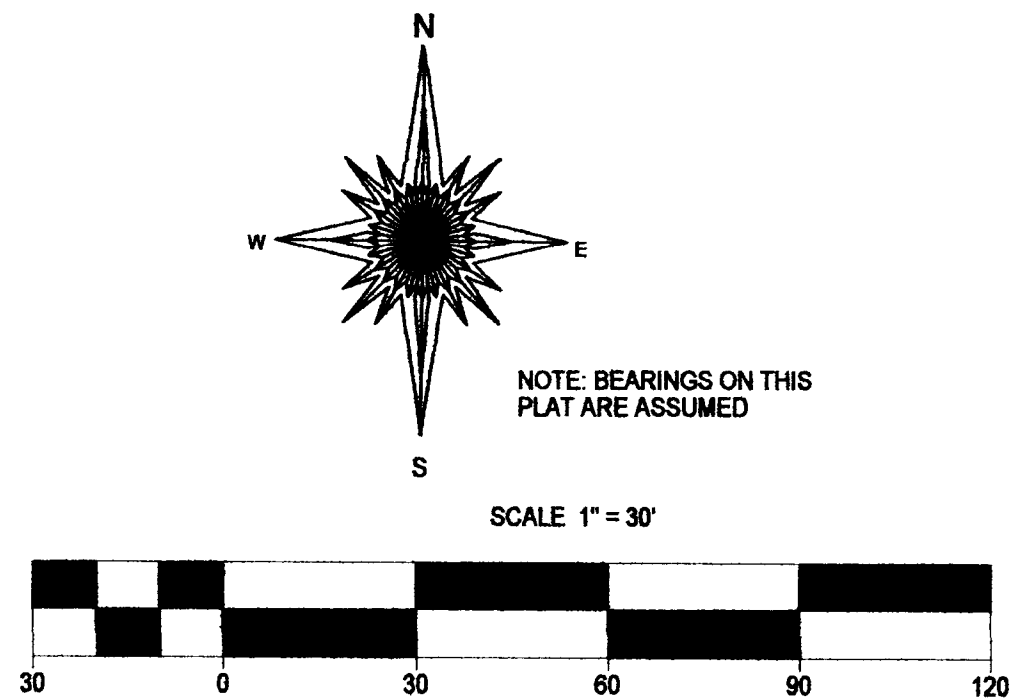



RECEIVED
DEC 10 2010
By *JMF*

JOB # 10-134
TAX ID # NGH 00033

"I hereby certify that I have surveyed the above described property and that the above map is a true representation of its exterior boundaries and shows the size and location of all visible structures, apparent easements and encroachments if any." This survey is made for the present owners of the property, and those who purchase, mortgage, or guarantee the title thereto, within one year from the date hereof.

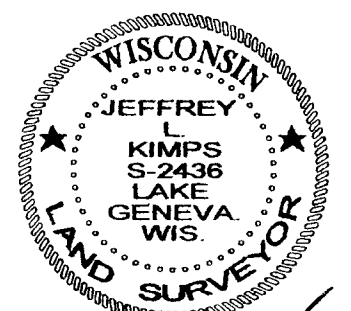
DATED THIS 14th DAY OF SEPTEMBER, 2010.





 JEFFREY L. KIMPS S. 2436
 Wisconsin Registered Land Surveyor
 (original if signed in red)