

PREPARED FOR
LAURA RODRIGUEZ
KEEFE REAL ESTATE
751 GENEVA PARKWAY
LAKE GENEVA WI. 53147

PLAT OF SURVEY

- OF -

LOT 11 OF THE SECOND ADDITION TO HEATHERIDGE, A SUBDIVISION
LOCATED IN SECTION 18, T.2.N., R.18.E., WALWORTH COUNTY, WISCONSIN.

KROTT SURVEYING INC.
N3705 WILLOW BEND LANE
LAKE GENEVA WI. 53147
PHONE # (262)248-3697
FAX # (262)249-0639

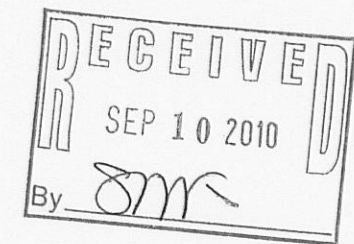

LEGEND

- FOUND IRON PIPE
- FOUND IRON BAR

(XX) RECORDED AS
TAX ID # HDE200011
JOB # 03-282UD

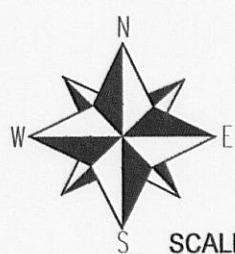

SCALE 1" = 30'

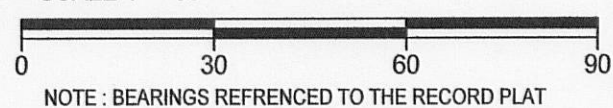

NOTE: BEARINGS REFERENCED TO THE RECORD PLAT

I have surveyed the above-described property and the above map is a true representation thereof and shows the size and location of the property, its exterior boundaries, the location and dimensions of all structures thereon, fences apparent easements and roadways and visible encroachments, if any.

This survey is made for the exclusive use of the present owners of the property, and also those who purchase, mortgage, or insure the title thereto within one (1) year from date hereof; and as to them I warrant the accuracy of said survey map.

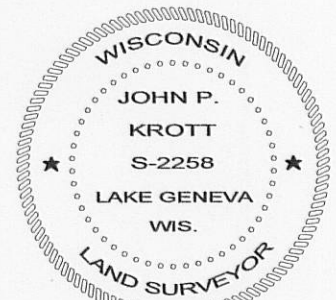

DATED THIS 25th DAY OF JUNE 2010.

[Signature]
JOHN KROTT S - 2258
Wisconsin Registered Land Surveyor
(original if signed in red)

NDE2-11

218-1755