

PLAT OF SURVEY  
-OF-

LOT 1 OF CERTIFIED SURVEY MAP NO. 4177, BEING A REDIVISION OF LOT 1 OF CERTIFIED SURVEY MAP NO. 4146 AS RECORDED IN VOLUME 26 OF CERTIFIED SURVEY MAPS ON PAGE 118 IN THE OFFICE OF THE REGISTER OF DEEDS FOR WALWORTH COUNTY, WISCONSIN, AND A PART OF THE NORTHWEST 1/4 OF THE SOUTHWEST 1/4 OF SECTION 16, TOWNSHIP 2 NORTH, RANGE 18 EAST OF THE FOURTH PRINCIPAL MERIDIAN, IN THE TOWNSHIP OF LYONS, WALWORTH COUNTY, WISCONSIN.

PREPARED FOR: BRIAN M. LOIS  
478 PLEASANT AVENUE  
BURLINGTON, WI 53105

I HEREBY CERTIFY THAT THE EXISTING DWELLING, UNDER CONSTRUCTION, SHOWN ON THIS PLAT OF SURVEY IS LOCATED AS SHOWN THUS ( ), DATED THIS 29TH DAY OF OCTOBER, 2008.

*Robert J. Wetzel*  
ROBERT J. WETZEL S-1778

WEST 1/4 CORNER  
SECTION 16-2-18  
N. = 234,813.38  
E. = 2,434,823.89

NOTE: RIGHT-OF-WAY PER  
SURVEY BY ERIC STURM.

BUILDABLE AREA IS ZONED A-1  
DWELLING SETBACK REQUIREMENTS  
STREET YARD = NOT LESS THAN 50 FEET  
SIDE YARD = NOT LESS THAN 20 FEET  
REAR YARD = NOT LESS THAN 100 FEET  
SHORE YARD = NOT LESS THAN 75 FEET

CURVE DATA

CENTERLINE  
DELTA = 21°31'11"  
RADIUS = 954.93'  
CHORD = 356.56'  
C.B. = N09°52'27"W  
TANGENT IN = N00°53'09"E  
TANGENT OUT = N20°38'02"W  
RIGHT-OF-WAY  
DELTA = 21°51'16"  
RADIUS = 987.93'  
CHORD = 374.50'  
C.B. = N09°41'12"W  
TANGENT IN = N01°14'22"E  
TANGENT OUT = N20°36'45"W  
RIGHT-OF-WAY  
TO MEANDER LINE  
DELTA = 18°20'52"  
RADIUS = 987.93'  
CHORD = 315.02'  
C.B. = N07°56'05"W

LEGEND

- FOUND BRASS CAPPED CONCRETE MONUMENT
- FOUND 1-5/16" O.D. IRON PIPE
- SET 1-5/16" O.D. X 18" IRON PIPE WEIGHING NOT LESS THAN 1.68 POUNDS PER LINEAL FOOT.
- SOIL BORING

NOTE: NO FURTHER DIVISION OF ANY LOT HEREIN WILL BE ALLOWED WITHIN 5 YEARS OF THE TOWN APPROVAL DATE SHOWN ON THE CERTIFIED SURVEY MAP. THIS RESTRICTION SHALL BE DEEMED TO RUN WITH THE LAND FOR THE TIME PERIOD SPECIFIED, REGARDLESS OF OWNERSHIP.

NOTE: SHORELAND BOUNDARY, FLOODPLAIN BOUNDARY & ZONING LINE PER WALWORTH COUNTY ZONING MAP OF SECTION 16-2-18.

SOIL TYPES: MmA & MyB

N70°00'30"E  
7.00'

BEARINGS HEREON RELATE TO THE WEST LINE OF THE SOUTHWEST 1/4 OF SECTION 16-2-18. ASSUMED BEARING IS NORTH 00°45'00" WEST.

NOTE: CONTOURS NOT SHOWN. LOT MEETS THE MINIMUM SLOPE REQUIREMENTS OF COMM-85 OF THE WISCONSIN ADMINISTRATIVE CODE.

DETAIL:  
SCALE: 1" = 40'

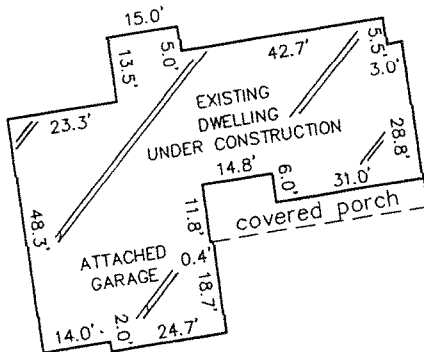

SCALE:

1" = 100'

THIS IS NOT AN ORIGINAL PRINT  
UNLESS THIS SEAL IS RED.

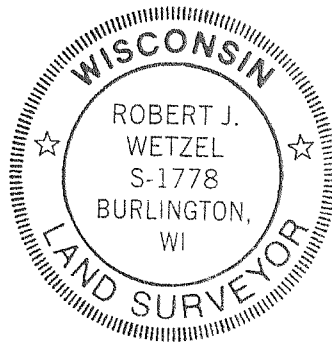

*Robert J. Wetzel*  
ROBERT J. WETZEL S-1778

JULY 21, 2008  
DATE

7914  
JOB NUMBER

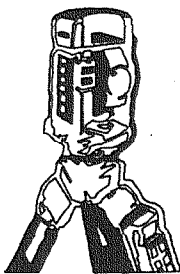

B.W. SURVEYING, INC.

LAND SURVEYS  
MAPPING AND PLANNING  
412 N. PINE STREET  
BURLINGTON, WI 53105  
(262)-767-0225

NA 4177-1

218-1712