

037161  
037161S1.DWG

ALL THAT PART OF LOT 20, BLOCK 2, BURKE & CAMPBELL'S ADDITION TO THE VILLAGE OF LYONS, WALWORTH COUNTY, WISCONSIN, ACCORDING TO THE RECORDED PLAT THEREOF, DESCRIBED AS FOLLOWS: COMMENCE AT A POINT ON THE EAST LINE OF SAID LOT, WHICH IS 55 FEET NORTH OF THE SOUTHEAST CORNER THEREOF; GO THENCE SOUTH 55 FEET ALONG SAID EAST LINE TO SAID SOUTHEAST CORNER; GO THENCE WEST ON THE SOUTH LINE OF SAID LOT 114.2 FEET TO THE SOUTHWEST CORNER THEREOF; GO THENCE NORTHERLY ALONG THE WESTERLY LINE OF SAID LOT, 89 FEET; THENCE EASTERLY TO THE POINT OF BEGINNING.

REFERENCE IS MADE TO PREVIOUS SURVEY  
BY HAROLD H. KOLB, DATED; JULY 29, 1976.

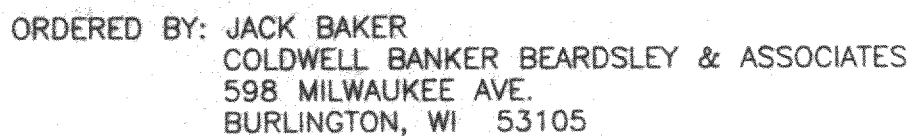

- - SET MAGNETIC NAIL
- - FOUND IRON PIPE
- - SET IRON PIPE
- ( ) - RECORDED AS

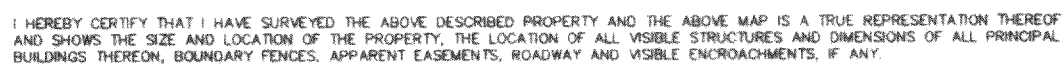

THIS SURVEY IS MADE FOR THE PRESENT OWNERS OF THE PROPERTY, AND ALSO THOSE WHO PURCHASE, OR GUARANTEE THE TITLE THERETO WITHIN (1) YEAR FROM THE DATE HEREOF.

DATED AT WATERFORD THIS 11th DAY OF JUNE 2003

RE CERTIFIED

NL-20A

218-1426