

SCALE
1" = 60'

LEGEND

- FOUND IRON ROD
- FOUND IRON PIPE
- FOUND IRON PIPE

GRAPHIC SCALE



DETAIL

SCALE: 1" = 30'

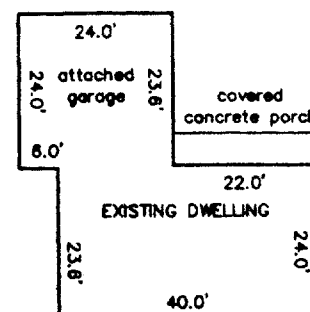

REMAINING LAND OF LOT 3
412,079 sq.ft.
9.46 acres

PROPOSED LANDS TO BE ADDED
BY LOT LINE ADJUSTMENT

217,821 sq.ft.
5.00 acres

PLAT OF SURVEY

-FOR-

PROPOSED LOT LINE ADJUSTMENT

-OF-

EXISTING PARCEL:

LOT 1, CERTIFIED SURVEY MAP NO. 3117, ACCORDING TO THE RECORDED PLAT THEREOF, RECORDED IN VOLUME 17 OF CERTIFIED SURVEYS ON PAGE 58 AS DOCUMENT NO. 417780, LOCATED IN THE NORTHEAST 1/4, NORTHWEST 1/4 AND SOUTHWEST 1/4 OF THE NORTHEAST 1/4 OF SECTION 33, TOWNSHIP 2 NORTH, RANGE 18 EAST OF THE FOURTH PRINCIPAL MERIDIAN, IN THE TOWNSHIP OF LYONS, WALWORTH COUNTY, WISCONSIN.

PROPOSED LANDS TO BE ADDED BY LOT LINE ADJUSTMENT:

PART OF LOT 3, CERTIFIED SURVEY MAP NO. 3117, ACCORDING TO THE RECORDED PLAT THEREOF, RECORDED IN VOLUME 17 OF CERTIFIED SURVEYS ON PAGE 58 AS DOCUMENT NO. 417780, LOCATED IN THE NORTHEAST 1/4, NORTHWEST 1/4 AND SOUTHWEST 1/4 OF THE NORTHEAST 1/4 OF SECTION 33, TOWNSHIP 2 NORTH, RANGE 18 EAST OF THE FOURTH PRINCIPAL MERIDIAN, IN THE TOWNSHIP OF LYONS, WALWORTH COUNTY, WISCONSIN AND BEING MORE PARTICULARLY DESCRIBED AS FOLLOWS: BEGIN AT THE NORTHWEST CORNER OF SAID LOT 3; THENCE NORTH 89°21'34" EAST ALONG THE NORTH LINE OF SAID LOT 3, 327.20 FEET; THENCE SOUTH 00°39'08" EAST 665.64 FEET TO A POINT ON THE SOUTH LINE OF SAID LOT 3; THENCE SOUTH 89°20'01" WEST ALONG SAID SOUTH LINE 327.20 FEET TO THE SOUTHWEST CORNER OF SAID LOT 3; THENCE NORTH 00°39'08" WEST ALONG THE WEST LINE OF SAID LOT 3, 665.79 FEET TO THE PLACE OF BEGINNING. CONTAINING 5.00 ACRES OF LAND MORE OR LESS.

SURVEY FOR: DALE R. LININGER

SURVEY LOCATION: 3037 W. CIRCLE DR.

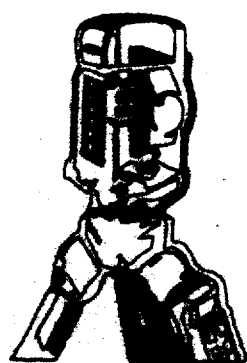
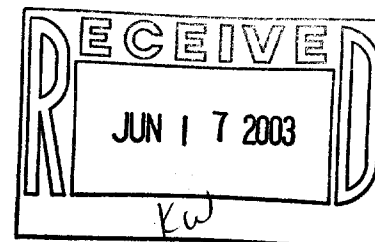

B.W. SURVEYING, INC.

412 N. PINE STREET
BURLINGTON, WI 53105
(262)-767-0225

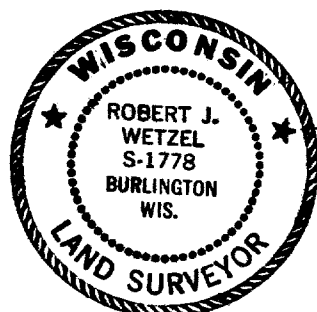

Robert J. Wetzel
ROBERT J. WETZEL S-1778

"I hereby certify that I have surveyed the above described property and that the above map is a correct representation thereof and shows the size and location of the property, its exterior boundaries, the location of all visible structures and dimensions of all principal buildings thereon, boundary fences, apparent easements, roadways and encroachments, if any."

"This survey is made for the use of the present owners of the property, and those who purchase, mortgage, or guarantee the title thereto within one year from date hereof."

DRAWN BY:	bjw	DATE:	MAY 27, 2003
CHECKED BY:	jts	DRAWING NO.:	
JOB NO.:	5899	SHEET	1 OF 1

NA3117-1
NA3117-3

218-1384