

WALWORTH COUNTY  
SURVEYING & MAPPING  
P. O. BOX 1115  
LAKE GENEVA, WISCONSIN 53147  
414-248-0505

PLAT OF SURVEY OF

LOT 16 OF PARTRIDGE WOODS, A SUBDIVISION  
LOCATED IN THE NW 1/4, THE SE 1/4 AND  
THE SW 1/4 OF SECTION 23, T 2 N, R 18 E,  
TOWN OF LYONS, WALWORTH COUNTY,  
WISCONSIN.

ORDERED BY: KEEFE REAL ESTATE  
751 GENEVA PARKWAY  
LAKE GENEVA, WISCONSIN  
53147

GRAPHIC SCALE

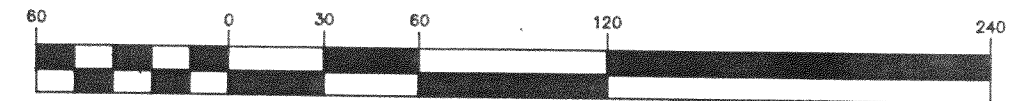

( IN FEET )  
1 inch = 60 ft.

- ⊘-IRON PIPE FOUND
- ⊘-IRON ROD FOUND
- CONCRETE MONUMENT FOUND
- IRON PIPE PLACED
- ( )-RECORDED AS

I HEREBY CERTIFY THAT I HAVE SURVEYED THE ABOVE DESCRIBED  
PROPERTY AND THAT THE ABOVE MAP IS A TRUE REPRESENTATION  
THEREOF AND SHOWS THE SIZE AND LOCATION OF THE PROPERTY,  
ITS EXTERIOR BOUNDARIES, THE LOCATION OF ALL VISIBLE STRUCTURES  
AND DIMENSIONS OF ALL PRINCIPAL BUILDINGS THEREON, BOUNDARY  
FENCES, APPARENT EASEMENTS, ROADWAYS AND VISIBLE ENCROACH-  
MENTS, IF ANY, TO THE BEST OF MY KNOWLEDGE AND BELIEF.

THIS SURVEY IS MADE FOR THE USE OF THE PRESENT OWNERS OF  
THE PROPERTY AND ALSO THOSE WHO PURCHASE, MORTGAGE OR  
GUARANTEE THE TITLE THERETO WITHIN ONE (1) YEAR FROM DATE  
HEREOF.

*Robert M. Baerenwald*  
ROBERT M. BAERENWALD  
WISCONSIN REGISTERED LAND SURVEYOR, S-1508

DATE Oct. 29, 1998 JOB NO. 5998

NOTE: THIS IS NOT A CERTIFIED COPY UNLESS SEALED.

DETAIL SCALE  
1"=30'

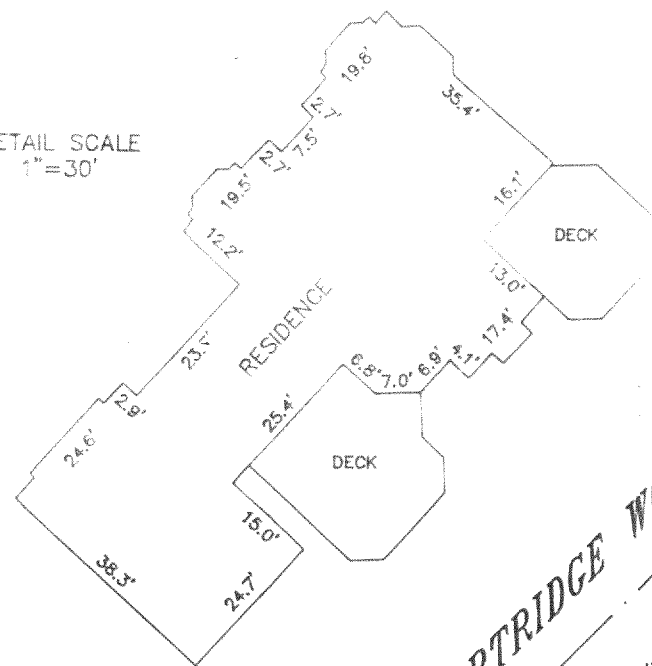

PARTRIDGE WOOD COURT

(N45°40'20"E 538.00')  
538.30'

12' WIDE UTILITY EASEMENT

16

460.04'  
(N89°50'50"E 459.68')

3.9' 2.4'

DOG PEN

17

(CH. N139°15'10"E 70.89')  
70.89'  
R=317.00'  
50°48'10"

RESIDENCE

DECK

DECK

ASPHALT DRIVEWAY

RESIDENCE

(S35°12'10"E 80.17')  
80.17'  
50.02'

145°06'25"

WIRE FENCE

(S00°01'07"E 388.61')  
388.57'

69°59'20"

KPRW-16 218-1242

