

ABERNATHY and ASSOCIATES

Kenneth B. Abernathy Jr.

Wisconsin Registered Land Surveyor S-1594

Rt. 3, Box 273
Elkhorn, Wisconsin 53121
Phone: (414) 723-4260 (office)
(414) 723-7209 (FAX)

PLAT OF SURVEY

LOT 9 OF LYONS HILLSIDE SUBDIVISION, LOCATED IN THE NORTHWEST 1/4 OF THE SOUTHEAST 1/4 OF SECTION 10, TOWN 2 NORTH, RANGE 18 EAST, TOWN OF LYONS, WALWORTH COUNTY, WISCONSIN.



ORDERED BY: DAN FINKE CONSTRUCTION
P.O. BOX 30
LYONS, WI. 53148

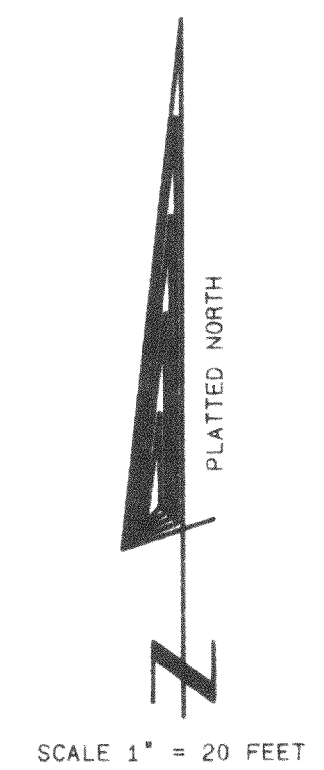

Legend

- FOUND IRON PIPE
- FOUND IRON ROD
- FOUND BRASS CAPPED MONUMENT
- ✱ FOUND CONCRETE MONUMENT
- + CHISEL CUT IN CONCRETE
- SET IRON ROD, 24" LONG, WEIGHING 1.5 LBS., LINEAL FT., 3/4" DIA.
- SET IRON ROD, 30" LONG, WEIGHING 4.5 LBS., LINEAL FT., 1 1/16" DIA.
- (XX) RECORDED AS DIMENSION
- EXISTING FENCE

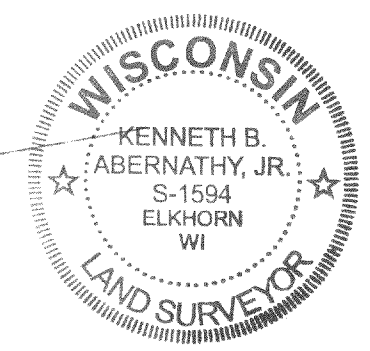
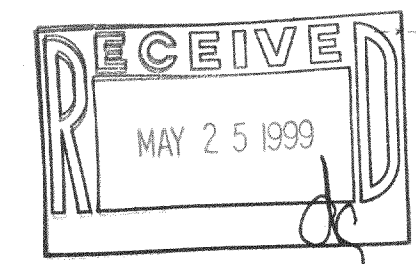

SCALE: 1" = 20 FEET

"I hereby certify that the above described property has been surveyed by me or under my direction and that the above map is a true representation thereof and shows the size and location of the property, its exterior boundaries, the location of all visible structures and dimensions of all principal buildings thereon, boundary fences, apparent easements, roadways and visible encroachments, if any."
"This survey is made for the use of the present owners of the property and also those who purchase, mortgage, or guarantee the title thereto within one year from date hereof."

Kenneth B. Abernathy, Jr.

KENNETH B. ABERNATHY, JR.
WISCONSIN REGISTERED LAND SURVEYOR,
S-1594

Date: MARCH 3, 1999 Job No. 99.301

REVISED 5/8/99 "AS BUILT LOCATION"

218-1056
NLH-9

DESIGN PRODUCTS 08/7/99