

ABERNATHY and ASSOCIATES

Kenneth B. Abernathy Jr.

Wisconsin Registered Land Surveyor S-1594

Rt. 3, Box 273
Elkhorn, Wisconsin 53121
Phone: (414) 723-4260 (office)
(414) 723-7209 (FAX)

PLAT OF SURVEY

LOT 9 OF LYONS HILLSIDE
SUBDIVISION, LOCATED IN THE
NORTHWEST 1/4 OF THE SOUTHEAST
1/4 OF SECTION 10, TOWN 2 NORTH,
RANGE 18 EAST, TOWN OF LYONS,
WALWORTH COUNTY, WISCONSIN.



ORDERED BY: DAN FINKE CONSTRUCTION
P.O. BOX 30
LYONS, WI. 53148

NOTE
WOOD STAKES HAVE BEEN PLACED AT BUILDING CORNERS.
BUILDER IS TO VERIFY DIMENSIONS WHICH HAVE BEEN
ROUNDED TO THE NEAREST TENTH OF A FOOT TO INSURE
PROPER PLAN INTERPRETATION AND CONTACT THIS OFFICE
IMMEDIATELY IF ANY DISCREPANCY EXISTS.

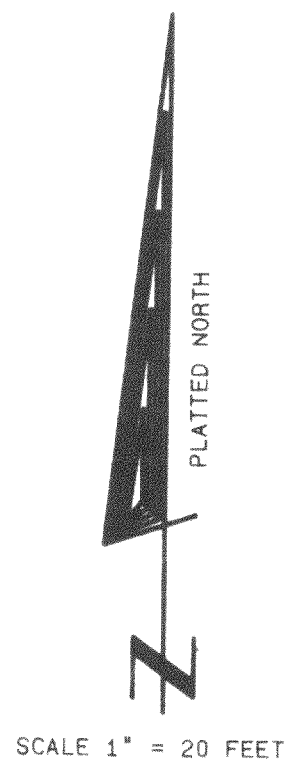

Legend

- FOUND IRON PIPE
- FOUND IRON ROD
- FOUND BRASS CAPPED MONUMENT
- ✱ FOUND CONCRETE MONUMENT
- CHISEL CUT IN CONCRETE
- SET IRON ROD 24" LONG WEIGHING 1.5 LBS LINEAL FT. 3/4" DIA.
- SET IRON ROD 30" LONG WEIGHING 4.5 LBS LINEAL FT. 1 1/16" DIA.
- (xx) RECORDED AS DIMENSION
- - - - - EXISTING FENCE

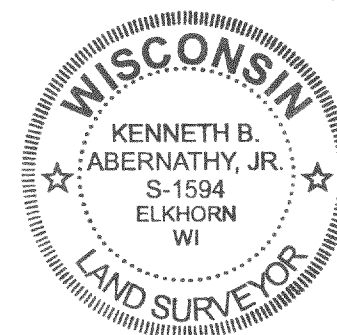

SCALE: 1" = 20 FEET

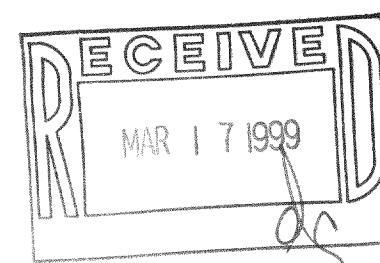

"I hereby certify that the above described property has been surveyed by me or under my direction and that the above map is a true representation thereof and shows the size and location of the property, its external boundaries, the location of all visible structures and dimensions of all principal buildings thereon, boundary fences, apparent easements, roadways and visible encroachments, if any."
"This survey is made for the use of the present owners of the property, and also those who purchase, mortgage, or guarantee the title thereto within one year from date hereof."

Kenneth B. Abernathy, Jr.
KENNETH B. ABERNATHY, JR.
WISCONSIN REGISTERED LAND SURVEYOR,
S-1594

Date: MARCH 3, 1999 Job No. 99-301

218-1053
NLH-9