

# DEGEN, FOAT SURVEYING ASSOCIATES

100 SOUTH SECOND STREET  
WATERFORD, WISCONSIN  
(414)534-5404 (FAX)534-2022

982194  
982194S1.DWG

## PLAT OF SURVEY

UNIT 20 OF BRIDLEWOOD ESTATES, A CONDOMINIUM LOCATED IN THE  
NORTHWEST 1/4 AND THE SOUTHWEST 1/4 OF SECTION 28 AND THE  
NORTHEAST 1/4 AND THE SOUTHEAST 1/4 OF SECTION 29, TOWN 2 NORTH,  
RANGE 18 EAST, TOWN OF LYONS, WALWORTH COUNTY, WISCONSIN.

SURVEYED FOR: HANDYMAN HAMILL CONSTRUCTION  
3823 RAYMOND AVENUE  
BROOKFIELD, IL 60513

MOELTER DRIVE

CB=N 88°54'25" E  
CH=83.74 ARC=83.83  
R=527.00

CB=S 56°38'22" E  
CH=159.84 ARC=163.15  
R=233.00

BRIDLEWOOD COURT

UNIT 20

UNIT 19

N 11°51'59" W - 171.92

S 76°42'00" E - 102.47

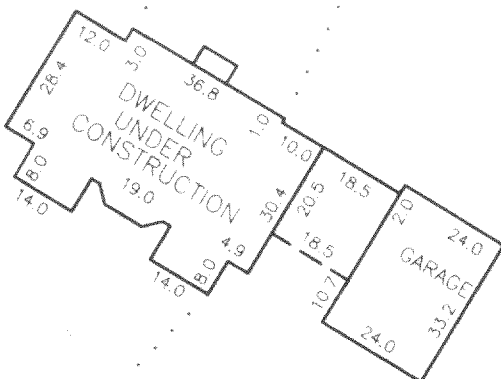

UNIT 23

N 45°36'01" W - 226.72

UNIT 21

### LEGEND

- ⊙ - FOUND IRON PIPE
- - FOUND IRON ROD
- - SET IRON PIPE
- - FENCE
- ( ) - RECORDED AS
- ♦ - SOIL BORING SCALED FROM SOILS REPORT

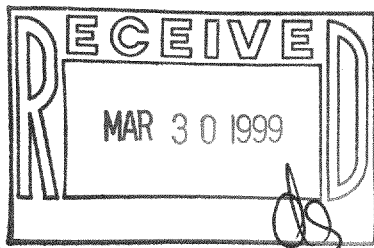

SCALE: 1" = 40'

I HEREBY CERTIFY THAT I HAVE SURVEYED THE ABOVE DESCRIBED PROPERTY AND THE ABOVE MAP IS A TRUE REPRESENTATION THEREOF AND SHOWS THE SIZE AND LOCATION OF THE PROPERTY, THE LOCATION OF ALL VISIBLE STRUCTURES AND DIMENSIONS OF ALL PRINCIPAL BUILDINGS THEREON, BOUNDARY FENCES, APPARENT EASEMENTS, ROADWAY AND VISIBLE ENCROACHMENTS, IF ANY.

THIS SURVEY IS MADE FOR THE PRESENT OWNERS OF THE PROPERTY, AND ALSO THOSE WHO PURCHASE, OR GUARANTEE THE TITLE THERETO WITHIN (1) YEAR FROM THE DATE HEREOF.

DATED AT WATERFORD THIS 26TH DAY OF MAY 19 98

RECERTIFIED AUGUST 20, 1998

*Greg E. Felt*

NBRE-20

218-1051