

PLAT OF SURVEY

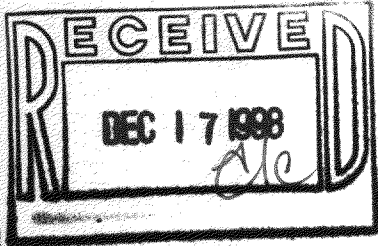

LOCATION: Partridge Woods Court, Lyons, Wisconsin

LEGAL DESCRIPTION: Lot 3 in PARTRIDGE WOODS, a subdivision located in the Northeast 1/4, the Southeast 1/4 and the Southwest 1/4 of Section 23, Town 2 North, Range 18 East, Town of Lyons, Walworth County, Wisconsin.

October 30, 1998

Survey No. 90287

S 00°05'05" E

754.36'

574.61'

S 69°02'30" E

HOUSE DETAIL
SCALE: 1"=30'

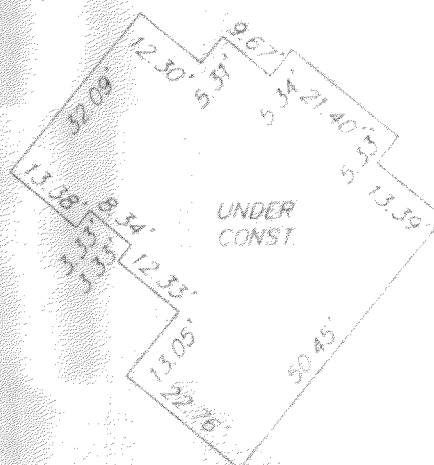

885.91'

S 89°21'35" E

N 45°40'20" E

PARTRIDGE

WOODS

COURT

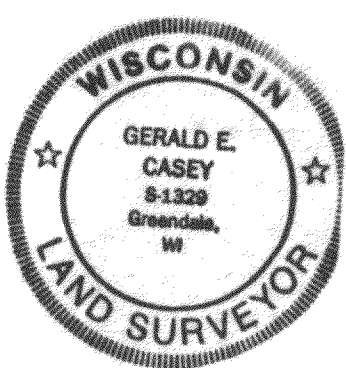

FIN. GRD.
91.36'



171.49'

134.79'

20.07'

180.00'

518.02'

S 19°22'00" E

160.95'
RAD = 583.00'
C/D = 199.71'
N 57°42'40" E

SCALE: 1"=60'

METROPOLITAN SURVEY SERVICE, INC.
REGISTERED LAND SURVEYORS
9415 W. FOREST HOME AVE., SUITE 202, HALES CORNERS, WI 53130
PH. 529-5390 FAX 529-9787

I HEREBY CERTIFY THAT I HAVE SURVEYED THE ABOVE DESCRIBED PROPERTY AND THAT THE ABOVE MAP IS A TRUE REPRESENTATION THEREOF AND SHOWS THE SIZE AND LOCATION OF THE PROPERTY, ITS EXTERIOR BOUNDARIES, THE LOCATION OF ALL VISIBLE STRUCTURES AND DIMENSIONS OF ALL PRINCIPAL BUILDINGS THEREON, BOUNDARY FENCES, APPARENT EASEMENTS AND ROADWAYS AND VISIBLE ENCROACHMENTS, IF ANY.

THIS SURVEY IS MADE FOR THE EXCLUSIVE USE OF THE PRESENT OWNERS OF THE PROPERTY, AND ALSO THOSE WHO PURCHASE, MORTGAGE, OR GUARANTEE THE TITLE THERETO WITHIN ONE (1) YEAR FROM DATE HEREOF.

SIGNED

Gerald E. Casey
Registered Land Surveyor 8-1329

NPRW-3

218-1030