

WALWORTH COUNTY SURVEYING & MAPPING

727 HENRY STREET
LAKE GENEVA, WISCONSIN
414-248-0505

6

IRON PIPE 0.65' SOUTH
AND 0.06' WEST OF LOT
CORNER

(S89°51'W 130.00')
130.18'

GRAND VIEW DRIVE

(NORTH 126.56')
126.71'

BLOCK 2

5

4

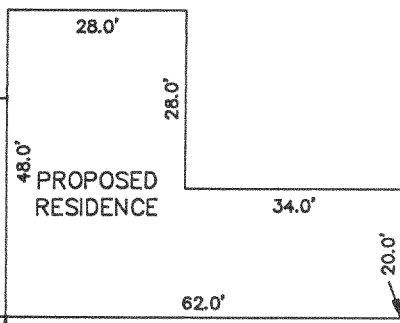

PROPOSED
RESIDENCE

(N45°00'W 35.36')
CH=25.92'
R=25.92'
135°10'
25.0'
8.0'
124°11'
27.3'

(S79°09'W 82.07')
CH=82.02'

(S70°25'W 25.95')
CH=25.92'
R=25.92'

MARS LANE
(MARK LANE)

R=261.00'

R=317.00'

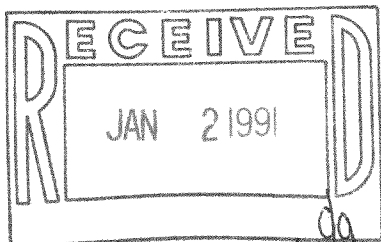

PLAT OF SURVEY OF

LOT 5, BLOCK 2 OF HAWTHORNE HILLS, LOCATED
IN SECTION 26, T 2 N, R 17 E, WALWORTH COUNTY,
WISCONSIN.

ORDERED BY: LAZZARONI BUILDERS
909 HENRY STREET
LAKE GENEVA, WISCONSIN
53147

I HEREBY CERTIFY THAT I HAVE SURVEYED THE ABOVE DESCRIBED
PROPERTY AND THAT THE ABOVE MAP IS A TRUE REPRESENTATION
THEREOF AND SHOWS THE SIZE AND LOCATION OF THE PROPERTY,
ITS EXTERIOR BOUNDARIES, THE LOCATION OF ALL VISIBLE STRUCTURES
AND DIMENSIONS OF ALL PRINCIPAL BUILDINGS THEREON, BOUNDARY
FENCES, APPARENT EASEMENTS, ROADWAYS AND VISIBLE ENCROACH-
MENTS, IF ANY, TO THE BEST OF MY KNOWLEDGE AND BELIEF.

THIS SURVEY IS MADE FOR THE USE OF THE PRESENT OWNERS OF
THE PROPERTY AND ALSO THOSE WHO PURCHASE, MORTGAGE OR
GUARANTEE THE TITLE THERETO WITHIN ONE (1) YEAR FROM DATE
HEREOF.

Robert M. Baerenwald
ROBERT M. BAERENWALD
WISCONSIN REGISTERED LAND SURVEYOR, S-1508

DATE Aug. 27, 1990 JOB NO. 2651

NOTE: THIS IS NOT A CERTIFIED COPY UNLESS SEALED.

SCALE IN FEET

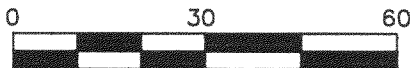

LEGEND
○-IRON PIPE FOUND
□-IRON ROD FOUND
■-CONCRETE MONUMENT FOUND
○-IRON PIPE PLACED
○-RECORDED AS

Survey # 217-893

TAX KEY # JHH 04013